



WELCOME LETTER

Dear Colleagues,

The 25th World Congress of the International College of Psychosomatic Medicine (ICPM) takes place at the Conference Centre Nuovo Ingresso di Careggi (NIC) located in Giulio Caccini street number 2 and at the Auditorium located in Largo Piero Palagi number 1, Florence, Italy from 11-13 September 2019.

It is a pleasure to welcome you in Florence. As we have tried to make a tradition, the cities we visit for the World Congress of the International College of Psychosomatic Medicine have a special relationship with ICPM members and with ICPM Presidents. This to give a strong flavor of the ICPM vision to the conference. We have also tried to make an innovation, using the World Congress as a lab to allow exchanges and commistions with societies interested in psychosomatics. ICPM offers you a high-quality, multidisciplinary scientific programme that will provide a full review of the most important aspects of Psychosomatic Medicine and latest achievements in this field.

Under the motto "The Psychosomatic Perspective", as a tribute to the ICPM inner mission, the Congress highlights include presentations by outstanding International experts in psychosomatics.

The scientific programme is composed of plenary lectures, update lectures, symposia, workshops, case presentations, posters, a tribute to the estimated colleague Per Bech who passed away on May 9, 2018, but still lives in our minds and hearts, and a tribute to the friend and colleague Massimo Rosselli who passed away on December 26, 2017, but would have been happy to seat here with us. Awards will be devoted to the four best posters presented during the congress and the Trust Sirigatti Award will be addressed to the best abstract for poster accepted.

We have developed an array of activities that will allow participants the opportunity to interact and network with colleagues from around the world.

We welcome you to the wonderful city of Florence,

Fiammetta Cosci

President of the Congress

ICPM President

Antonio Barbosa

President of the Congress

ICPM Past President



TABLE OF CONTENTS

Congress General Information Overview

Sponsors.....	3
Venue Maps.....	4
Congress general information	5
Registration desk.....	5
Internet zone and wi-fi.....	5
Information for speakers.....	5
Information for poster presenters	5
Abstracts publication	6
Awards	6
ICPM 2019 Congress Committees	7
ICPM Boards	8
Psychosomatic Specialist Certification	9
ICMP Journal.....	9
Special congress event	10

Scientific programme Overview

Scientific programme Overview	11
Scientific programme by day.....	12
Wednesday 11 th September.....	12
Thursday 12 th September.....	25
Friday 13 th September.....	55
Poster Programme by day.....	83
Wednesday 11 th September.....	84
Thursday 12 th September.....	90
Friday 13 th September.....	98



ICPM 2019
www.icpmonline.org

25th WORLD CONGRESS OF THE ICPM - FINAL PROGRAMME

general information

SPONSORED BY



UNIVERSITÀ
DEGLI STUDI
FIRENZE

DSS
Dipartimento di
Scienze della Salute



WORLD PSYCHIATRIC ASSOCIATION
*WPA Section on Psycho-Oncology
& Psychiatry in Palliative Care*



COLLEGIO DEI PROFESSORI E DEI RICERCATORI DI
PSICOLOGIA CLINICA



GRP GRUPPO DI RICERCA
IN PSICOSOMATICA



SOCIETÀ ITALIANA
DI PSICHIATRIA
DI CONSULENZA



fondata nel 1966

SOCIETÀ ITALIANA
DI MEDICINA PSICOSOMATICA





VENUE LAYOUT

Conference Centre Nuovo Ingresso di Careggi (NIC) via Giulio Caccini, 2

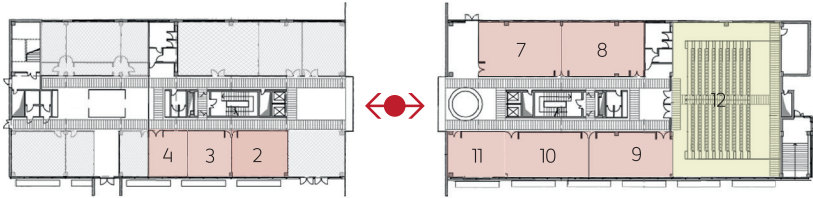

Auditorium Largo Piero Palagi, 1

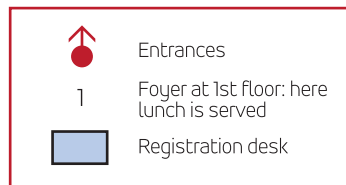
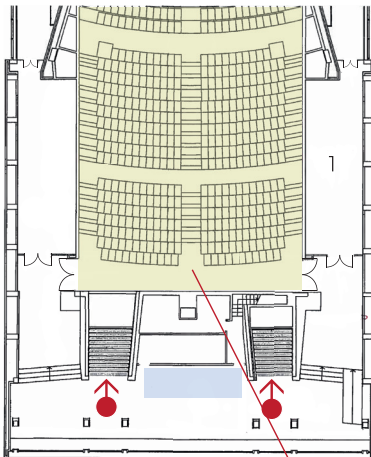

Auditorium



CONGRESS GENERAL INFORMATION

CONGRESS VENUE

Conference Centre Nuovo Ingresso di Careggi (NIC) via Giulio Caccini, 2 & Auditorium Largo Piero Palagi, 1 Florence, Italy.

REGISTRATION DESK

Registration desk is situated on the **ground floor of the Auditorium** Largo Piero Palagi, 1.

CERTIFICATE OF ATTENDANCE

You will receive your Certificate of Attendance **via email before the end of the event.**

INTERNET ZONE & WIFI

Free internet facilities are available for all Congress participants in the exhibition area, during the exhibition opening hours.

At the Conference Centre Nuovo Ingresso di Careggi (NIC), please use the **Wi-Fi network** named **eduroam** or named **AOUCunifiWiFi**, the username and password are written in the paper you will find in the congress bag.

At the Auditorium, please use the **Wi-Fi network** named **ICPM2019**, the password is **icpm2019**.

ABOUT THE INTERNATIONAL COLLEGE OF PSYCHOSOMATIC MEDICINE

Find out more at: <http://www.icpmonline.org/>.

CONGRESS SECRETARIAT

Contact the ICPM Secretariat via email at: info@icpmonline.org.

INFORMATION FOR SPEAKERS

If your presentation is scheduled at the **Auditorium**, please **ask the personnel of the Auditorium** to save your slides **at least 30 minutes before** the beginning of the lecture/symposium. If your presentation is scheduled at the **Conference Centre Nuovo Ingresso di Careggi (NIC)**, please **ask the personnel of the Slide Center** to save your slides **at least 1 hour before** the beginning of the symposium/workshop/clinical case presentation/oral presentation.

INFORMATION FOR POSTER PRESENTERS

A "poster code on the programme" was assigned to the title of each poster to identify



it. A "poster number on the poster board" was assigned to the title of each poster, this will help you locate your poster on the poster board. Poster sessions will take place in the Auditorium Hall (ground floor). Each poster must be in LANDSCAPE format, printed, and should not be bigger than 80 cm high x 90 cm wide. Any poster printed in portrait or larger than 80 cm high x 90 cm wide may not be displayed at the congress. We recommend that posters are printed on paper, as cloth does not sufficiently attach to the boards. The posters will be mounted on boards, tapes will be provided by ICPM. Each poster board is one-sided with two posters on the same side. The boards will be arranged in numerical order in the Auditorium hall, the numbers will be in the right-hand side of poster boards. The poster sessions have a designated time in which the poster presenters are requested to set up (please see the online poster programme as well as the printed programme you will find in your congress bag), be available at their poster to discuss their research with the meeting attendees (please see the online programme at a glance as well as the printed programme you will find in your congress bag), and to tear down (please see the online poster programme as well as the printed programme you will find in your congress bag). Please remove your poster promptly during the scheduled removal times. ICPM will not be responsible for any posters left in the exhibit area after the scheduled removal times.

ABSTRACTS PUBLICATION

The Congress **Abstract Book** will be published as a **Supplement of Psychotherapy and Psychosomatics** (2018 Impact Factor: 13.744). Each accepted abstract will become retrievable through the Web of Science. The supplement will include plenary lectures, update lectures, symposia presentations, workshop presentations, case reports and all accepted poster presentations. Abstract Book will be retrievable for download from the following links: <https://www.karger.com/Journal/Home/223864>; <http://www.icpmonline.org/25th-world-congress-florence-2019>.

AWARDS

ICPM BEST POSTER AWARDS: The ICPM offers €250 best poster awards to the 4 best posters presented at the 25th ICPM World Congress. A Commission will evaluate the posters ON SITE. The awards will be assigned to the first author. The winners will be awarded during the Closing Ceremony on Friday 13th September 2019.

TRUST SIRIGATTI AWARD IN MEMORY OF MASSIMO ROSSELLI: The "Saulo Sirigatti Trust for studies and research in psychology" offers a € 800 award in memory of Massimo Rosselli for the best abstract for poster accepted at the 25th ICPM World Congress. The winner will be awarded during the symposium "Culture and practice of psychosomatics: a tribute to Massimo Rosselli" on Thursday 12th September 2019.



ICPM 2019 CONGRESS COMMITTEE

ICPM 25TH WORLD CONGRESS PRESIDENTS

Fiammetta Cosci (Florence, Italy)
Antonio Barbosa (Lisbon, Portugal)

INTERNATIONAL ADVISORY COMMITTEE

Chairman: Giovanni Andrea Fava (Italy)

Iqbal Ahmed (USA)
Michael Bagby (Canada)
Richard Balon (USA)
Per Bech (Danmark)
Massimo Biondi (Italy)
Michael Bourke (Iceland)
Eva-Lotta Brakemeier (Germany)
Ricardo Campos (Spain)
Jianxin Cao (China)
Graça Cardoso (Portugal)
André Carvalho (Brazil)
Guy Chouinard (Canada)
George Christodoulou (Greece)
John De Figueredo (USA)
Hans-Christian Deter (Germany)
Dan Dumitrascu (Romania)
Paul Emmelkamp (The Netherlands)
Secondo Fassino (Italy)
Maurizio Fava (USA)
Fabien Gagnon (Canada)
Pierangelo Geppetti (Italy)
Luigi Grassi (Italy)
Carlos Grilo (USA)
Jenny Guidi (Italy)
Peter Henningsen (Germany)
Lee Hochang (USA)
Seyed Davood Hosseini (United Arab Emirates)
Hasse Karlsson (Finland)
Gabor Keitner (USA)
Kyung Bong Koh (South Korea)
Mira Lal (UK)
Hoyle Leigh (USA)
Cédric Lemogne (France)
Paolo Leombruni (Italy)
Michael Linden (Germany)
Dennis Linder (Italy)
Don Lipsitt (USA)

Antonio Lobo (Spain)
Aleksandra Luszczynska (Poland)
Andreas, Maercker (Switzerland)
Jose Maldonado (USA)
Antonino Minervino (Italy)
Driss Moussaoui (Morocco)
Finian O'Brien (Malaysia)
Emanuela Offidani (USA)
Charles Peretti (France)
Piero Porcelli (Italy)
Chiara Rafanelli (Italy)
Darius Razavi (Belgium)
Winfried Rief (Germany)
Marco Rigatelli (Italy)
Gary Rodin (Canada)
Massimo Rosselli (Italy)
Mirella Ruggeri (Italy)
Ulrich Schnyder (Switzerland)
Wolfram Schüffel (Germany)
Tom Sensky (UK)
Consoli Silla (France)
Tatjana Sivik (Sweden)
Wolfgang Sollner (Germany)
Nicoletta Sonino (Italy)
Hubert Speidel (Germany)
David Spiegel (USA)
Fredric Stiefel (Switzerland)
James Strain (USA)
Jon Streltzer (USA)
Nobuyuki Sudo (Japan)
Diogo Telles-Correia (Portugal)
Elena Tomba (Italy)
Carmelo Vazquez (Spain)
Tom Wise (USA)
Jesse Wright (USA)
Yonggui Yuan (China)
Stephan Zipfel (Germany)



ICPM BOARDS

EXECUTIVE BOARD

President: Fiammetta Cosci (Italy)

Secretary: Hochang Benjamin Lee (USA)

Treasurer: Nobuyuki Sudo (Japan)

President-Elect: Kyung Bong Koh (S. Korea)

Past-President: Antonio Barbosa (Portugal)

ADVISORY BOARD

George Christodoulou (Greece)

Giovanni Fava (Italy)

Chiharu Kubo (Japan)

Don Lipsitt (USA)

Tom Sensky (United Kingdom)

Tatjana Sivik (Sweden)

Jon Streltzer (USA)

Thomas Wise (USA)



PSYCHOSOMATIC SPECIALIST CERTIFICATE

The Psychosomatic Specialist Certificate is a Title given by the International College on Psychosomatic Medicine which recognizes and supports physicians and Ph.D. level clinical psychologists who practice Psychosomatic Medicine across different disciplines. The Psychosomatic Specialists awarded from October 2017 to September 2019 will receive the Certificate during the opening ceremony of the 25th World Congress on Psychosomatic Medicine.

PSYCHOSOMATIC SPECIALIST EVALUATION COMMITTEE

Chairman: Thomas N. Wise (USA)

Members: Antonio Barbosa (Portugal), Luigi Grassi (Italy)

THE OFFICIAL JOURNAL OF THE ICPM

PSYCHOTHERAPY AND PSYCHOSMATICS is the the official Journal of ICPM (2018 Impact Factor 13.744). It has become a unique and vital reference to current research and practice, the home of innovative thinking at the interface between medical and behavioral sciences.

Editor-in-Chief: Giovanni Fava (Italy)

Associate Editors: Fiammetta Cosci (Italy), Elena Tomba (Italy)

For more information: www.karger.com/PPS



SPECIAL CONGRESS EVENTS



WEDNESDAY 11TH SEPTEMBER 2019



OPENING CEREMONY

14.00

Auditorium



MUSICAL ENTERTAINMENT

18.00

Auditorium



WELCOME RECEPTION

Auditorium

18.15

THURSDAY 12TH SEPTEMBER 2019



CONGRESS DINNER (NOT included in the Main Conference fee)

19.30

Villa Finaly

Via Bolognese 134/R Florence

FRIDAY 13TH SEPTEMBER 2019



CLOSING CEREMONY

17.30

Auditorium



SCIENTIFIC PROGRAMME OVERVIEW

The ICPM 2019 Scientific Programme is composed of 7 main tracks:

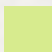
 PRE-CONGRESS Workshop

 Plenary Lecture

 Symposium

 Workshop

 Case presentation

 Update Lecture

Posters



SCIENTIFIC PROGRAMME
WEDNESDAY

Wednesday, 11th September 2019



ICPM 2019
www.icpmonline.org

Wednesday, 11th September 2019

09.00-12.00

Aula Magna - NIC

PRE-CONGRESS Workshop 1

CLINICAL USE OF THE DIAGNOSTIC CRITERIA FOR PSYCHOSOMATIC RESEARCH - REVISED

Chair:	J. Cao (<i>China</i>)
09.00	J. Cao (<i>China</i>)
09.45	A. Eory (<i>Hungary</i>)
10.30	G.A. Fava (<i>Italy, US</i>)
11.15	S. Gostoli (<i>Italy</i>)

Sponsored by Gruppo di Ricerca in Psicomatica (GRP)

12.00-14.00 *REGISTRATION to Auditorium & POSTER EXHIBITION to Auditorium*

Wednesday, 11th September

Wednesday, 11th September 2019

09.00-12.00

Sifneos Room (Room 7) – NIC

PRE-CONGRESS Workshop 2

CLINICAL USE OF RATING SCALES

- Chair:** S.D. Østergaard (*Denmark*)
- 09.00 **THE DEVELOPMENT OF THE BECH-RAFAELSEN MANIA SCALE (MAS) AND THE CLINICAL APPLICATIONS OF A 10-ITEM MODIFIED SUBSCALE – THE MAS-M**
S.P. Straszek (*Denmark*)
- 09.30 **THE HAMILTON RATING SCALES FOR DEPRESSION: THE 17-ITEM VERSION (HAM-D17) COMPARED TO THE 6-ITEM VERSION (HAM-D6)**
S.B. Møller (*Denmark*)
- 10.00 **THE PATIENT HEALTH QUESTIONNAIRE (PHQ-9) COMPARED TO THE MAJOR DEPRESSION INVENTORY (MDI)**
K.S. Christensen (*Denmark*)
- 10.30 **THE CLINICAL VALIDITY OF THE HOPKINS SYMPTOM CHECKLIST: A SYSTEMATIC REVIEW**
D. Carrozzino (*Italy*)
- 11.00 **THE WHO-5 WELL-BEING INDEX**
S.D. Østergaard (*Denmark*)
- 11.30 **THE USE OF MEASUREMENT-BASED CARE IN MENTAL HEALTH**
M. Pio de Almeida Fleck (*Brazil*)

09.00-12.00

Kellner Room (Room 8) - NIC

PRE-CONGRESS Workshop 3

BURN OUT

- 09.00 **M. Linden** (*Germany*)

12.00-14.00 *REGISTRATION to Auditorium & POSTER EXHIBITION to Auditorium*

Wednesday, 11th September 2019

09.00-12.00

Lipowski Room (Room 10) - NIC

PRE-CONGRESS Workshop 4

COGNITIVE BEHAVIORAL ANALYSIS SYSTEM OF PSYCHOTHERAPY (CBASP) FOR THE TREATMENT OF CHRONIC DEPRESSION

09.00 E.L. Brakemeier (*Germany*)
I. Schamong (*Germany*)

09.00-12.00

Engel Room (Room 9) - NIC

PRE-CONGRESS Workshop 5

THE CLINICAL APPROACH IN PSYCHODERMATOLOGY

Chairs: D. Linder (*Austria, Israel*)
U. Gieler (*Qatar*)
C. Fazekas (*Austria*)

09.00 **THE PSYCHOIMMUNOLOGICAL PATHWAYS OF CHRONIC SKIN DISEASES**

U. Gieler (*Qatar*)

09.35 **BODY DYSMORPHIC DISORDERS**

T. Gieler (*Germany*)

10.10 **PSYCHIATRIC LIAISON CONSULTATION IN DERMATOLOGY**

T. Lahousen-Luxenberger (*Austria*)

10.45 **A CASE REPORT OF SEVERE PSORIASIS**

L. Tomas-Aragones (*Spain*)

11.30 **BOTH DYSMORPHOPHOBIA AND SELF INFLICTED SKIN LESIONS: A CLINICAL CASE PRESENTATION**

D. Linder (*Austria, Israel*)

12.00-14.00 **REGISTRATION to Auditorium & POSTER EXHIBITION to Auditorium**

Wednesday, 11th September 2019

09.00-12.00

Kissen Room (Room 11) - NIC

PRE-CONGRESS Workshop 6

FAMILY THERAPY

09.00 **G. Keitner (US)**

14.00-15.00

Auditorium

OPENING CEREMONY

15.00-16.00

Auditorium

Plenary Lecture 1

THE STRENGTH OF PSYCHOSOMATIC MEDICINE

Chair: **A. Barbosa (Portugal)**

Speaker: **G.A. Fava (Italy, US)**

Sponsored by Gruppo di Ricerca in Psicomatica (GRP)

16.00-16.30 *BREAK & POSTER EXHIBITION to Auditorium*

Wednesday, 11th September 2019

16.30-18.00

Auditorium

Symposium 1

EMBITTERMENT, UNDERRECOGNIZED IN PSYCHIATRY AND PSYCHOSOMATIC MEDICINE

Chairs: M. Linden (*Gemrnay*)
H. Znoj (*Switzerland*)

16.30 **CLINICAL FEATURES AND ASSOCIATED SYMPTOMS OF EMBITTERMENT**

H. Znoj (*Switzerland*)

16.50 **THE RELATION BETWEEN EMBITTERMENT AND DEMORALIZATION**

M.G. Nanni (*Italy*)

17.10 **IMPAIRMENT ACROSS DIFFERENT AREAS IN LIFE IN EMBITTERED PERSONS**

M. Linden (*Germany*)

17.30 **TESTING THE EFFECTIVENESS OF AN EXPRESSIVE WRITING INTERVENTION ON EMBITTERED EMPLOYEES. RESULTS OF A RANDOMIZED CONTROLLED STUDY**

E. Michailidis (*UK*)

18.00-18.15 *MUSICAL ENTERTAINMENT to Auditorium*

18.15-19.30 *WELCOME RECEPTION to Auditorium*

Wednesday, 11th September 2019

16.30-18.00

Aula Magna - NIC

Symposium 2

THE CLINIMETRIC APPROACH TO RATING SCALES: A TRIBUTE TO PER BECH

- Chairs:** G.A. Fava (*Italy, US*)
M. Pio de Almeida (*Brazil*)
- 16.30 **WHY THE 6-ITEM VERSION OF THE HAMILTON DEPRESSION RATING SCALE SHOULD BE PREFERRED IN DRUG TRIALS ON DEPRESSION**
R.W. Licht (*Denmark*)
- 16.45 **DIAGNOSING DEPRESSION IN PRIMARY CARE: A RASCH ANALYSIS OF THE MAJOR DEPRESSION INVENTORY (MDI)**
K. S. Christensen (*Denmark*)
- 17.00 **CLINICAL VALIDATION OF RATINGS ON THE 6-ITEM POSITIVE AND NEGATIVE SYNDROME SCALE (PANSS-6) OBTAINED USING THE SIMPLIFIED NEGATIVE AND POSITIVE SYMPTOMS INTERVIEW (SNAPSI)**
S.D. Østergaard (*Denmark*)
- 17.15 **CONTRIBUTION OF PER BECH TO MEASUREMENT-BASED CARE**
M. Pio de Almeida Fleck (*Brazil*)
- 17.30 **PSYCHOMETRIC VALIDATION ANALYSIS OF EYSENCK'S NEUROTICISM AND EXTRAVERSION SCALES IN A SAMPLE OF FIRST TIME DEPRESSED PATIENTS**
S.B. Møller (*Denmark*)
- 17.45 **THE CLINIMETRIC APPROACH TO THE ASSESSMENT OF PSYCHOLOGICAL DISTRESS: A VALIDATION ANALYSIS OF THE HOPKINS SYMPTOM CHECKLIST (SCL-90-R)**
D. Carrozzino (*Italy*)
- 18.00-18.15 *MUSICAL ENTERTAINMENT to Auditorium*
- 18.15-19.30 *WELCOME RECEPTION to Auditorium*

Wednesday, 11th September 2019

16.30-18.00

Sifneos Room (Room 7) - NIC

Symposium 3

EARLY LIFE STRESS IN AFFECTIVE DISORDERS: LOOKING FOR MARKERS OF IMPACT ON BODY AND BRAIN

- Chairs:** **A. Young (UK)**
 B. Etain (France)
- 16.30 **CHILDHOOD MALTREATMENT AND THE PHYSICAL BURDEN OF PATIENTS WITH BIPOLAR DISORDERS**

 B. Etain (France)
- 16.50 **TELOMERE LENGTH IS ASSOCIATED WITH CHILDHOOD TRAUMA IN PATIENTS WITH SEVERE MENTAL DISORDERS**

 M. Aas (Norway)
- 17.10 **GENETIC, HPA AXIS ACTIVITY AND EARLY LIFE STRESS IMPACT IN AFFECTIVE DISORDERS**

 M.F. Juruena (UK)
- 17.30 **BIOMARKERS FOR DIAGNOSIS AND TREATMENT OF BIPOLAR DISORDER: HOPE OR HYPE?**

 A. Young (UK)
- 18.00-18.15 *MUSICAL ENTERTAINMENT to Auditorium*
- 18.15-19.30 *WELCOME RECEPTION to Auditorium*

Wednesday, 11th September

Wednesday, 11th September 2019

16.30-18.00

Kellner Room (Room 8) - NIC

Symposium 4

PSYCHOSOMATICS MATTERS: STRESS AND MEDICALLY UNEXPLAINED COMPLAINTS

- Chairs:** R.J. van der Gaag (*Latvia-The Netherlands*)
G. Ancane (*Latvia*)
- 16.30 **THE “MEDICALLY UNEXPLAINED” VERSUS “SOMATICALLY UNEXPLAINED”**
G. Ancane (*Latvia*)
- 16.50 **TO WHOM AND ABOUT WHAT PATIENTS WANT TO TALK**
B. Palmowski (*Germany*)
- 17.10 **SPECIALISATION IN PSYCHOSOMATIC MEDICINE WITHIN AND ACROSS DISCIPLINES**
C. Fazekas (*Austria*)
- 17.30 **PSYCHOSOMATICS AND THE MANAGEMENT OF STRESS. IMPORTANT FOR ANY DOCTOR**
R.J. van der Gaag (*The Netherlands*)
- 18.00-18.15 *MUSICAL ENTERTAINMENT to Auditorium*
- 18.15-19.30 *WELCOME RECEPTION to Auditorium*

Wednesday, 11th September 2019

16.30-18.00

Lipowski Room (Room 10) - NIC

Symposium 5

MULTIDIMENSIONAL APPROACHES IN PSYCHO-ONCOLOGY

- Chairs:** C. Simionato (*Italy*)
L. Del Piccolo (*Italy*)
- 16.30 **SOCIAL DREAMING MATRIX AND “DREAM ICONS”**
D. Agresta (*Italy*)
- 16.50 **HYPNOSIS AND “IMAGINATIVE TECHNIQUES”**
L. Merati (*Italy*)
- 17.10 **THE BALINT METHOD FOR PROFESSIONALS IN PSYCHO-ONCOLOGY**
A. Suman (*Italy*)
- 17.30 **COMPARING THE CONTRIBUTION OF PSYCHOLOGICAL INFLEXIBILITY AND COPING MEASURES TO EXPLAIN ADJUSTMENT TO CANCER**
M. Paroli (*Italy*)

Sponsored by Società Italiana di Medicina Psicosomatica (SIMP)

18.00-18.15 *MUSICAL ENTERTAINMENT to Auditorium*

18.15-19.30 *WELCOME RECEPTION to Auditorium*

Wednesday, 11th September

Wednesday, 11th September 2019

16.30-18.00

Engel Room (Room 9) - NIC

Symposium 6

TAPPING TOUCH – A HOLISTIC CARE METHOD: ITS EMPIRICAL RESEARCH AND CLINICAL PRACTICE

- Chairs:** I. Nakagawa (*Japan*)
Y. Fukui (*Japan*)
- 16.30 **THE THEORY AND PRACTICE OF TAPPING TOUCH**
I. Nakagawa (*Japan*)
- 16.50 **RECENT FINDINGS REGARDING THE RELATIONAL EFFECTS SPECIFIC TO TAPPING TOUCH**
Y. Fukui (*Japan*)
- 17.10 **CONDITIONS WHICH INFLUENCE THE RELATIONAL EFFECTS OF TAPPING TOUCH**
S.I. Oura (*Japan*)
- 17.30 **THE SOCIAL EFFECTS OF TAPPING TOUCH IN SCHOOL SOCIAL WORK: A CASE STUDY**
Y. Nakagawa (*Japan*)

Sponsored by The Association of Tapping Touch

18.00-18.15 *MUSICAL ENTERTAINMENT to Auditorium*

18.15-19.30 *WELCOME RECEPTION to Auditorium*

Wednesday, 11th September 2019

16.30-18.00

Kimball Room (Room 2) - NIC

Symposium 7

PARENTAL BURNOUT: A CONDITION THAT DESERVES URGENT ATTENTION

- Chairs:** M. Mikolajczak (*Belgium*)
C. Vazquez (*Spain*)
- 16.30 **EARLY DETECTION OF PARENTAL BURNOUT IN PRIMARY CARE SETTINGS: WHY AND HOW?**
M. Sorkkila (*Finland*)
- 16.50 **BIOLOGICAL MARKERS FOR PARENTAL BURNOUT: THE CASE OF HAIR CORTISOL**
M.O. Mikolajczak (*Belgium*)
- 17.10 **EFFECT SIZE OF PARENTAL BURNOUT ON SOMATIC SYMPTOMS AND SLEEP DISORDERS**
A. Sarrionandia (*Spain*)
- 17.30 **TREATING PARENTAL BURNOUT: COMPARATIVE EFFICIENCY OF TWO PSYCHOLOGICAL INTERVENTIONS**
M.E. Brianda (*Belgium*)
- 18.00-18.15 *MUSICAL ENTERTAINMENT to Auditorium*
- 18.15-19.30 *WELCOME RECEPTION to Auditorium*

Wednesday, 11th September

Wednesday, 11th September 2019

16.30-18.00

Kissen Room (Room 11) - NIC

Symposium 8

SPIRITUALITY IN PALLIATIVE CARE

- Chairs:** P. Chandra (*India*)
A. Vespa (*Italy*)
- 16.30 **SPIRITUAL SCREENING IN PALLIATIVE CARE SETTINGS- WHAT QUESTIONS CAN CLINICIANS ASK?**
P. Chandra (*India*)
- 16.50 **SPIRITUAL CONCERNS AND COPING IN PALLIATIVE CARE IN INDIA**
S. Chaturvedi (*India*)
- 17.10 **DEVELOPMENT OF A SPIRITUAL DISTRESS SCALE FOR PALLIATIVE CARE PATIENTS IN INDIA**
J. Gielen (*US*)
- 17.30 **SPIRITUALITY AND QUALITY OF LIFE IN PALLIATIVE CARE: EFFECTS OF SPIRITUALITY ON THE QUALITY OF LIFE AND MOOD IN PATIENTS AND HEALTH-WORKERS**
A. Vespa (*Italy*)
- 18.00-18.15 *MUSICAL ENTERTAINMENT to Auditorium*
- 18.15-19.30 *WELCOME RECEPTION to Auditorium*



SCIENTIFIC PROGRAMME
THURSDAY

Thursday, 12th September 2019



ICPM 2019
www.icpmonline.org

Thursday, 12th September 2019

09.00-10.30

Auditorium

Symposium 9

TACKLING IRRITABLE BOWEL SYNDROME (IBS), AN INTERDISCIPLINARY PERSPECTIVE

Chairs: B. Coffin (*France*)
S. Zipfel (*Germany*)

09.00 PATHOPHYSIOLOGY OF IBS (INCLUDING MICROBIOTA)

B. Coffin (*France*)

09.30 TREATMENT

N. Mazurak (*Germany*)

10.00 OVERLAP OF FUNCTIONAL SOMATIC DISORDERS AND IMPLICATION FOR TREATMENT

S. Zipfel (*Germany*)

09.00-10.30

Aula Magna - NIC

Symposium 10

UPDATES ON THE DIAGNOSTIC CRITERIA FOR PSYCHOSOMATIC RESEARCH (DCPR)

Chairs: J. Cao (*China*)
P. Leombruni (*Italy*)

09.00 PSYCHOSOCIAL FACTORS ASSOCIATED WITH THE OCCURRENCE OF DCPR SYNDROMES IN ASTHMA PATIENTS

A. Woźniewicz (*Poland*)

09.20 DCPR RELATED PROBLEMS IN CLINICAL PRACTICE FOR NON-PSYCHIATRIC MEDICAL SETTINGS

J. Cao (*China*)

09.45 DCPR-R SYNDROMES OF ADULT CHRONIC PAIN OUTPATIENTS, PRELIMINARY RESULTS

A. Eőry (*Hungary*)

10.10 DCPR-R AND SOMATIC SYMPTOM DISORDER (SSD) IN PATIENTS WITH SEVERE IRRITABLE BOWEL SYNDROME (IBS)

C. Conti (*Italy*)

10.30 – 11.00 BREAK & POSTER EXHIBITION to Auditorium

Thursday, 12th September 2019

09.00-10.30

Sifneos Room (Room 7) - NIC

Symposium 11

THE LONG SHADOW OF EARLY LIFE STRESS

- Chairs:** H. Karlsson (*Finland*)
H. Grabe (*Germany*)
- 09.00 **DISTINGUISHING THE IMPACT OF DIFFERENT EARLY-LIFE ADVERSITIES ON ADULT ATTACHMENT, ALEXITHYMIA, AND PSYCHOPATHOLOGY**
J. Kajanoja (*Finland*)
- 09.20 **CHILDHOOD TRAUMA, 5-HTTLPR AND VITAMIN D**
H. Grabe (*Germany*)
- 09.45 **ALEXITHYMIA MEDIATES THE RELATIONSHIP OF CHILDHOOD TRAUMA AND IMPAIRED DECLARATIVE MEMORY PERFORMANCE IN THE GENERAL POPULATION**
J. Terock (*Germany*)
- 10.10 **PATERNAL EARLY LIFE STRESS AND NEWBORN BRAIN DEVELOPMENT**
H. Karlsson (*Finland*)
- 10.30 – 11.00 *BREAK & POSTER EXHIBITION to Auditorium*

Thursday, 12th September 2019

09.00-10.30

Kellner Room (Room 8) - NIC

Symposium 12

IMPACT OF FUNCTIONING, DISABILITY AND HEALTH IN CLINICAL AND NON-CLINICAL CONTEXTS

Chairs: L. Grassi (*Italy*)

M. Linden (*Germany*)

09.00 **ASSESSMENT OF NEEDED PSYCHOLOGICAL CAPACITIES IN THE WORKPLACE: THE Mini-ICF-APP-W**

M. Linden (*Germany*)

09.40 **ONE-YEAR CHANGES IN CAPACITY AND PARTICIPATION IN PATIENTS WITH SCHIZOPHRENIA AND BIPOLAR I DISORDER TREATED IN COMMUNITY-BASED MENTAL HEALTH SERVICES IN ITALY**

M. Balestrieri (*Italy*)

10.20 **EMOTIONAL AND COGNITIVE FUNCTIONING IN PATIENTS WITH CHRONIC PAIN**

D. Laera (*Italy*)

Sponsored by World Psychiatric Association (WPA) - Section on Psychiatry, Medicine and Primary Care

10.30 – 11.00 *BREAK & POSTER EXHIBITION to Auditorium*

Thursday, 12th September 2019

09.00-10.30

Lipowski Room (Room 10) - NIC

Symposium 13

THE MOVING SEMINAR (MOSE) - BUILDING UP TRUST

- Chairs: W. Schüffel (*Germany*)
 A. Schueler-Schneider (*Germany*)
- 09.00 M. Langer (*Germany*)

09.30-10.30

Engel Room (Room 9) - NIC

Workshop 1

TO COMMUNICATE, INTERACT AND MAKE DECISION WHEN DEALING WITH A SERIOUS ILLNESS: THE 'ADVANCE CARE PLANNING' (ACP) COMMUNICATION TOOL. RESULTS FROM THE EUROPEAN ACTION TRIAL ON ACP IN ONCOLOGY

- Chairs: T. Sensky (*UK*)
 F. Ingravallo (*Italy*)
- 09.30 **THE ACTION EUROPEAN STUDY: MAIN RESULTS**
 F. Ingravallo (*Italy*)
- 10.00 **THE IMPACT OF ACP ON PATIENT'S RELATIONSHIPS**
 A. Toccafondi (*Italy*)

10.30 – 11.00 BREAK & POSTER EXHIBITION to Auditorium

Thursday, 12th September 2019

09.30-10.30

Kimball Room (Room 2) - NIC

Workshop 2

USING EXPERIENTIAL GROUP WORK TO PROMOTE SELF-CARE AND HEALTH BEHAVIOR

Chair: S. Haramati (*Israel*)

09.30 **HEALTH PROMOTION**

S. Haramati (*Israel*)

10.00 **SELF-CARE FOR THERAPISTS**

A. Cohen (*Israel*)

09.30-10.30

Kissen Room (Room 11) - NIC

Case presentation 1

SUCCESSFUL TREATMENT OF A TREATMENT RESISTANT DEPRESSED DIABETIC PATIENT WITH BORDERLINE PERSONALITY TRAITS

Chair: L. Lencioni (*US*)

Discussants: D. Kawagoe (*US*)

L. Whitworth (*US*)

Speaker: V. Leigh (*US*)

10.30 – 11.00 *BREAK & POSTER EXHIBITION to Auditorium*

Thursday, 12th September 2019

11.00-12.30

Auditorium

Update Lecture 1

Chairs: J. Fiedorowicz (*US*)
G. Keitner (*US*)

THE QUALITY OF THE PSYCHOTHERAPY RELATIONSHIP IS CORRELATED TO OUT-COME, BUT HOW HELPFUL IS THIS FINDING?

Speaker: F. Caspar (*Switzerland*)

Sponsored by International Federation for Psychotherapy (IFP)

A PSYCHIATRIST AMONG SURGEONS: CARDIAC SURGERY AS A RESEARCH PARADIGM FOR TESTING HYPOTHESES ABOUT LATE LIFE NEUROPSYCHIATRIC SYMPTOMS

Speaker: H.B. Lee (*US*)

11.00-12.30

Aula Magna - NIC

Symposium 14

REAPPRAISAL OF ALEXITHYMIA IN CURRENT CLINICAL PRACTICE

Chairs: M. Bagby (*Canada*)
S. Chaturvedi (*India*)

11.00 **THE DEVELOPMENT AND VALIDATION OF AN INFORMANT VERSION OF THE 20-ITEM TORONTO ALEXITHYMIA SCALE**

M. Bagby (*Canada*)

11.15 **IS ALEXITHYMIA A CV RISK FACTOR IN HEALTHY ADULTS?**

C. Conti (*Italy*)

11.30 **CULTURAL FACTORS IN ALEXITHYMIA**

K. S. Chaturvedi (*India*)

11.50 **ALEXITHYMIA AND DEPRESSION- IS THERE A RELATIONSHIP?**

R. Sagar (*India*)

12.10 **ASSOCIATION OF CHRONIC PAIN AND ALEXITHYMIA**

G. Desai (*India*)

12.00-14.00 *BREAK LUNCH to Auditorium & POSTER EXHIBITION to Auditorium*

Thursday, 12th September

Thursday, 12th September 2019

11.00-12.30

Sifneos Room (Room 7) - NIC

Symposium 15

DYNAMICS OF POSITIVE AFFECT REGULATION AND HEALTH

- Chairs:** A. Ong (*US*)
J. Moskowitz (*US*)
- 11.00 **PREDICTING HEALTH OUTCOMES FROM TIME SERIES FEATURES OF AFFECT DYNAMICS: A MACHINE LEARNING APPROACH**
N. Roque (*US*)
- 11.15 **FRAGILE POSITIVE AFFECT AND SYSTEMIC INFLAMMATION**
A. Ong (*US*)
- 11.30 **EMOTION VARIABILITY CHANGE IN RESPONSE TO A POSITIVE EMOTION REGULATION INTERVENTION FOR PEOPLE WITH ELEVATED DEPRESSION**
J. Moskowitz (*US*)
- 11.50 **A MAP OF COGNITIVE AND AFFECTIVE CHANGES AFTER CBT AND POSITIVE PSYCHOTHERAPY: A NETWORK ANALYSIS**
C. Vazquez (*Spain*)
- 12.10 **EXPLORING DYNAMICS IN PARANOIA AFTER A POSITIVE PSYCHOLOGY GROUP INTERVENTION: NETWORK ANALYSIS WITH ESM**
C. Valiente (*Spain*)
- 12.00-14.00 **BREAK LUNCH to Auditorium & POSTER EXHIBITION to Auditorium**

Thursday, 12th September 2019

11.00-12.30

Kellner Room (Room 8) - NIC

Symposium 16

SONNO E PSICHE: TRA NEUROPLASTICITÀ E PSICOSOMATICA

- Chairs:** L. Grassi (*Italy*)
P. Girardi (*Italy*)
- 11.00 **PSYCOSOMATICS OF SLEEP**
A. Minervino (*Italy*)
- 11.15 **SLEEP DEPRIVATION, NEUROPLASTICITY AND PSYCHOPATHOLOGY**
G. Biggio (*Italy*)
- 11.30 **SLEEP AND PSYCHOPATHOLOGY: THE NEURODEVELOPMENTAL AND NEURODEGENERATIVE PERSPECTIVE**
L. Nobili (*Italy*)
- 11.50 **SLEEP, CIRCADIAN DE-SYNCHRONIZATION AND EMOTION DYSREGULATION IN PSYCHOPATHOLOGY**
L. Palagini (*Italy*)
- 12.10 **SLEEP AND STRESS-RESILIENCE DIMENSION IN PSYCHOPATHOLOGY**
P. Girardi (*Italy*)

Sponsored by Società Italiana di Medicina Psicosomatica (SIMP) & Gruppo di Ricerca in Psicosomatica (GRP)

(in Italian)

12.00-14.00 **BREAK LUNCH to Auditorium & POSTER EXHIBITION to Auditorium**

Thursday, 12th September 2019

11.00-12.30

Lipowski Room (Room 10) - NIC

Symposium 17

PSYCHODERMATOLOGY: A NEW FRONTIER IN PSYCHOSOMATIC MEDICINE

- Chairs:** M. Jafferany (*US*)
L. Tomas-Aragones (*Spain*)
- 11.00 **PSYCHOSOCIAL PERSPECTIVES**
M. Jafferany (*US*)
- 11.25 **MINDING THE SKIN**
L. Tomas-Aragones (*Spain*)
- 11.50 **SLEEP AND SKIN: WHAT DO WE KNOW?**
L. Mostaghimi (*US*)
- 12.10 **PSYCHOPATHOLOGICAL ASPECTS IN ALOPECIA AREATA**
A. Miranda-Sivelo (*Spain*)
- 12.00-14.00 *BREAK LUNCH to Auditorium & POSTER EXHIBITION to Auditorium*

Thursday, 12th September 2019

11.00-12.30

Engel Room (Room 9) - NIC

Symposium 18

EARLY LIFE EXPOSURE TO UNPREDICTABLE MATERNAL SIGNALS INFLUENCES CHILD DEVELOPMENT

Chairs: R. Korja (*Finland*)

E. Holmberg (*Finland*)

11.00 **MATERNAL UNPREDICTABLE SIGNALS ARE RELATED TO INFANT'S EMOTIONAL ATTENTION AT 8 MONTHS**

E. Eskola (*Finland*)

11.25 **THE ASSOCIATIONS BETWEEN MATERNAL EXECUTIVE FUNCTIONS, MATERNAL UNPREDICTABLE SIGNALS AND CHILD EXECUTIVE FUNCTIONS AT 30 MONTHS**

E. Nordenswan (*Finland*)

11.50 **STABILITY OF MATERNAL BEHAVIORAL ENTROPY RATE BETWEEN 8 AND 30 MONTHS OF CHILD'S AGE**

E. Holmberg (*Finland*)

12.10 **THE EFFECTS OF MATERNAL UNPREDICTABLE SIGNALS AT 8 MONTHS ON CHILD'S SELF-REGULATION AND SOCIO-EMOTIONAL PROBLEMS DURING TODDLERHOOD**

R. Korja (*Finland*)

12.00-14.00 *BREAK LUNCH to Auditorium & POSTER EXHIBITION to Auditorium*

Thursday, 12th September

Thursday, 12th September 2019

11.00-12.00

Kimball Room (Room 2) - NIC

Workshop 3

TRADITIONAL AND CURRENT APPROACHES IN BALINT GROUPS

Chair: A. Suman (*Italy*)

11.00 THE BALINT GROUP AS A RESOURCE IN PSYCHOSOMATIC MEDICINE TRAINING FOR HEALTH PROFESSIONALS

S. Grassi (*Italy*)

11.30 SOME REFLECTIONS ON THE EXPERIENCE OF BALINT GROUPS

P. Palumbo (*Italy*)

(In Italian)

11.00-12.00

Kissen Room (Room 11) - NIC

Case presentation 2

CHILDBIRTH EXPERIENCE AND PSYCHOSOMATIC CHALLENGES

Chair: M. Riba (*US*)

Discussant: G. Maina (*Italy*)

Speaker: M. Lal (*UK*)

12.00-14.00 BREAK LUNCH to Auditorium & POSTER EXHIBITION to Auditorium

Thursday, 12th September 2019

13.30-15.00

Auditorium

Symposium 19

LIMITS OF ANTIDEPRESSANT USE IN ANXIETY AND OBSESSIVE-COMPULSIVE DISORDER

Chairs: A.E. Nardi (*Brazil*)
E. Silberman (*US*)

13.30 **THE USE OF SSRIS IN PANIC DISORDER PATIENTS**

A.E. Nardi (*Brazil*)

13.55 **RESISTANCE TO ANTIDEPRESSANTS IN OCD PATIENTS**

U. Albert (*Italy*)

14.15 **DISTINGUISHING TREATMENT RESISTANT DEPRESSION FROM ANXIETY DISORDERS**

E. Silberman (*US*)

14.40 **THE PHENOMENON OF WITHDRAWAL AFTER DISCONTINUATION OF SSRI**

F. Cosci (*Italy*)

15.00 – 15.30 *BREAK & POSTER EXHIBITION to Auditorium*

Thursday, 12th September 2019

13.30-15.00

Aula Magna - NIC

Symposium 20

LIVING THE GOOD LIFE WITH A DISABILITY: WELL BEING AND THE FOUNDATIONAL PRINCIPLES OF REHABILITATION PSYCHOLOGY

Chairs: B. Nierenberg (US)
D. Rohe (US)

13.30 THE FOUNDATIONAL PRINCIPLES OF REHABILITATION PSYCHOLOGY

D. Dunn (US)

13.55 THE LINK BETWEEN POSITIVE PSYCHOLOGY AND THE FOUNDATIONAL PRINCIPLES

S. Wegener (US)

14.15 THE MYTHS OF HAPPINESS AND THE FOUNDATIONAL PRINCIPLES

D. Rohe (US)

14.40 THE APPLICATION OF WELL BEING THERAPY TO LIVING WITH A DISABILITY OR CHRONIC ILLNESS: EXTENDING THE FOUNDATIONAL PRINCIPLES TO INTERVENTION STRATEGIES

B. Nierenberg (US)

15.00 – 15.30 BREAK & POSTER EXHIBITION to Auditorium

Thursday, 12th September 2019

13.30-15.00

Sifneos Room (Room 7) - NIC

Symposium 21

PSYCHOSOCIAL IMPLICATIONS IN CANCER CARE

Chairs: M. Riba (*US*)

J.M. de Figueiredo (*US*)

13.30 UPDATING ISSUES IN THE NCCN GUIDELINES ON DISTRESS IN CANCER

M. Riba (*US*)

13.55 THE RELATIONSHIP BETWEEN SPIRITUALITY AND PSYCHOSOCIAL DIMENSIONS IN CANCER PATIENTS

R. Caruso (*Italy*)

14.15 UNMET NEEDS IN ONCOLOGY, A WAY TO FURTHER TARGET THE THERAPY

P. Leombruni (*Italy*)

14.40 CANCER PREVENTION AND CARE AMONG PEOPLE WITH SEVERE MENTAL ILLNESS

L. Grassi (*Italy*)

Sponsored by World Psychiatric Association (WPA) - Section on Psycho-Oncology and Palliative Care & by World Psychiatric Association (WPA) - Section on Psychiatry, Medicine & Primary care

15.00 – 15.30 BREAK & POSTER EXHIBITION to Auditorium

Thursday, 12th September 2019

13.30-15.00

Kellner Room (Room 8) - NIC

Symposium 22

PSYCHOSOMATICS IN THE PERSPECTIVE OF CHAOS AND COMPLEXITY SCIENCE: AN INTERDISCIPLINARY APPROACH TO EVALUATE PSYCHOSOMATIC FACTORS AFFECTING PATIENTS WITH MEDICAL DISORDERS

- Chairs:** M. Fulcheri (*Italy*)
D. Dumitrascu (*Romania*)
- 13.30 **PSYCHOSOMATIC: A COMPLEXITY SCIENCE BASED APPROACH**
G. Paoloni (*Italy*)
- 13.55 **CHAOS ANALYSIS OF EMOTIONAL PATTERNS IN PATIENTS WITH CHRONICAL DISEASES: IMPLICATIONS IN THE DISEASE MANAGEMENT**
C. Ciuluvica (*Italy*)
- 14.15 **PSYCHOLOGICAL ADVICE AND THERAPY IN IRRITABLE BOWEL SYNDROME**
D. Dumitrascu (*Romania*)
- 14.40 **NEW FRONTIERS IN THE LONG-TERM MANAGEMENT OF ATOPIC DERMATITIS: AN INTERDISCIPLINARY APPROACH**
P. Amerio (*Italy*)

Sponsored by Associazione Italiana di Psicologia (AIP)

15.00 – 15.30 *BREAK & POSTER EXHIBITION to Auditorium*

Thursday, 12th September 2019

14.00-15.00

Lipowski Room (Room 10) - NIC

Workshop 4

PSYCHOSOMATIC ASPECTS OF GASTROENTEROLOGY

Chair: S.B. Møller (*Denmark*)

Speaker: T. Sensky (*UK*)

14.00-15.00

Engel Room (Room 9) - NIC

Workshop 5

DIFFERENT WAYS TO TAKE CARE OF PAIN AND SUFFERING IN CHRONIC ILLNESS: PAINTING, WRITING ONES LIVE STORY, NARRATIVE MEDICINE AND VISUALIZA- TIONS

Chair: T. Sivik (*Sweden*)

Speakers: M.P. Urbani (*Italy*)

M.R. Zigliani (*Italy*)

G. Chiarini (*Italy*)

T. Sivik (*Sweden*)

(In Italian)

15.00 – 15.30 BREAK & POSTER EXHIBITION to Auditorium

Thursday, 12th September 2019

14.00-15.00

Kimball Room (Room 2) - NIC

Case presentation 3

PATIENTS WITH INCESTUOUS DREAMS – THE UNSOLVED OEDIPAL CONFLICT – PATRICK SWAYZE AND A LAW STUDENT

Chair: W. Schüffel (*Germany*)

Discussant: M. Langer (*Germany*)

Speaker: A. Schueler-Schneider (*Germany*)

14.00-15.00

Kissen Room (Room 11) - NIC

Case presentation 4

THE WOMB AND THE WHEELCHAIR- DISSOCIATION IN THE POSTPARTUM PERIOD

Chair: G. Maina (*Italy*)

Discussants: A. Bramante (*Italy*)

R. Sagar (*India*)

Speaker: P. Chandra (*India*)

15.00 – 15.30 *BREAK & POSTER EXHIBITION to Auditorium*

Thursday, 12th September 2019

15.30-17.00

Auditorium

Update Lecture 2

Chairs: A. Barbosa (*Portugal*)
C. Kubo (*Japan*)

PSYCHOBIOLOGY IN ANOREXIA NERVOSA

Speaker: S. Zipfel (*Germany*)

PSYCHOSOMATIC ISSUES IN ENDOCRINOLOGY

Speaker: N. Sonino (*Italy*)

15.00-16.30

Aula Magna - NIC

Symposium 23

HOT-SPOTS IN PSYCHOTRAUMATOLOGY: CONCEPTUAL CHANGES AND EMPIRICAL FINDINGS ABOUT ICD-11 STRESS-RELATED DISORDERS

Chairs: V. Köllner (*Germany*)

A. Maercker (*Switzerland*)

15.00 ADJUSTMENT DISORDER AND POSTTRAUMATIC STRESS SYMPTOMS AMONG ORGAN TRANSPLANT PATIENTS AND THEIR RELATIVES: A SYSTEMATIC APPROACH

V. Köllner (*Germany*) & J. Baumann (*Germany*)

15.20 PROLONGED GRIEF DISORDER AND ITS CULTURALLY SENSITIVE ASSESSMENT

A. Maercker (*Switzerland*)

15.40 COMPLEX POSTTRAUMATIC STRESS DISORDER IN THE CONTEXT OF WORKING LIFE: WORK-RELATED EXPERIENCE- AND BEHAVIOURAL PATTERNS, WORKING ABILITY AND CAPACITY

L. Brenner (*Germany*)

16.00 HOW PTSD AND COMPLEX PTSD AFFECT THE FAMILY SYSTEM: INTERPERSONAL AND INTERGENERATIONAL RAMIFICATIONS OF WAR TRAUMA

R. Bachem (*Israel*)

Thursday, 12th September 2019

15.30-17.00

Sifneos Room (Room 7) - NIC

Symposium 24

CLINICALLY USED STANDARDIZED PSYCHOMETRIC ASSESSMENT OF PHARMACOLOGICALLY INDUCED ALTERED STATES OF CONSCIOUSNESS (ASCS): STATE OF THE ART AND QUO VADIS?

- Chairs:** K. Stocker (*Switzerland*)
M. Liechti (*Switzerland*)
- 15.30 ACUTE EFFECTS OF LSD IN HEALTHY SUBJECTS AND IN PATIENTS DURING LSD-ASSISTED PSYCHOTHERAPY
M. Liechti (*Switzerland*)
- 15.55 AT EASE – SUBJECTIVE EFFECTS OF MDMA IN PLACEBO-CONTROLLED STUDIES WITH HEALTHY SUBJECTS
P. Vizeli (*Switzerland*)
- 16.15 ACUTE EFFECTS OF MDMA AND LSD AND THEIR RELATION TO OUTCOME IN THE SUBSTANCE-ASSISTED TREATMENT OF COMPLEX PTSD
P. Oehen (*Switzerland*)
- 16.40 CLINICAL POTENTIAL OF KETAMINE-INDUCED ALTERED STATES OF CONSCIOUSNESS (ASCS): SOME LESSONS FOR FURTHER PSYCHOMETRIC DEVELOPMENT FROM INTERNET VIDEO TESTIMONIALS OF DEPRESSED INDIVIDUALS RECEIVING KETAMINE INFUSIONS
K. Stocker (*Switzerland*)

Thursday, 12th September 2019

15.30-17.00

Kellner Room (Room 8) - NIC

Symposium 25

PAIN REHABILITATION TREATMENT WITH COMPLEX POPULATIONS

- Chairs:** W.P. Gilliam (*US*)
J.A. Sperry (*US*)
- 15.30 **LATENT GROWTH MODELING ANALYSIS OF CHANGES IN PAIN CATASTROPHIZING DURING INTERDISCIPLINARY PAIN REHABILITATION TREATMENT**
J.A. Sperry (*US*)
- 15.55 **EFFECT OF OPIOID USE ON TREATMENT OUTCOMES OF A MULTI-DISCIPLINARY PAIN REHABILITATION PROGRAM**
T.D. Schneekloth (*US*)
- 16.15 **AVOIDANT RESTRICTIVE FOOD INTAKE DISORDER IN ADOLESCENTS WITH CHRONIC PAIN**
L.A. Sim (*US*)
- 16.40 **PSYCHOSOCIAL TREATMENT FOR CHRONIC PAIN AND PTSD: EVIDENCE OF MEDIATION AND CLINICALLY SIGNIFICANT CHANGE FOLLOWING INTERDISCIPLINARY PAIN REHABILITATION**
W.P. Gilliam (*US*)

Thursday, 12th September 2019

15.30-17.00

Lipowski Room (Room 10) - NIC

Symposium 26

PSYCHOPATHOLOGY OF PREGNANCY AND PUERPERIUM – GLIMPSES FROM INDIA AND ITALY

- Chairs:** P. Chandra (*India*)
G. Maina (*Italy*)
- 15.30 **DENIAL OF PREGNANCY**
A. Bramante (*Italy*)
- 15.55 **FEAR OF BIRTH AND TOKOPHOBIA**
V. Brenna (*Italy*)
- 16.15 **PERINATAL OBSESSIVE-COMPULSIVE DISORDER**
G. Maina (*Italy*) & G. Rosso (*Italy*)
- 16.40 **SOMATIC SYMPTOMS IN PREGNANCY**
G. Desai (*India*)

Thursday, 12th September 2019

15.30-17.00

Engel Room (Room 9) - NIC

Symposium 27

AFFECTIVE NEUROSCIENCE FOR PSYCHOSOMATICS

- Chairs:** L. Grassi (*Italy*)
M. Farinelli (*Italy*)
- 15.30 **SELF-OTHER DISTINCTION: THE ROLE OF THE OXYTOCINERGIC SYSTEM**
V. Colonnello (*Italy*)
- 15.55 **EMOTION REGULATION AND BRAIN CORRELATES**
D. Cutuli (*Italy*)
- 16.15 **NEURO-AFFECTIVE AND RELATIONAL COMPONENTS OF PAIN IN A REHABILITATION SETTING**
C. Romaniello (*Italy*)
- 16.40 **NOVEL APPROACH TO LIFESTYLE: INTEGRATING NEUROAFFECTIVE AND RELATIONAL FACTORS**
G. Leonardi (*Italy*)

Thursday, 12th September 2019

15.30-16.30

Kimball Room (Room 2) - NIC

Workshop 6

Chairs: Y. Fukui (*Japan*)
M. Rus Makovec (*Slovenia*)

15.30 **TAPPING TOUCH - A HOLISTIC CARE METHOD: PSYCHO-SOMATIC EXPERIENCE OF HUMAN CARE**

I. Nakagawa (*Japan*)

16.00 **HOW CAN DOCTORS AND PATIENTS TOLERATE UNCERTAINTY OF FUNCTIONAL DISORDERS BETTER: PSYCHIATRIC AND SYSTEMIC PSYCHOTHERAPEUTIC PERSPECTIVE**

M. Rus Makovec (*Slovenia*)

15.30-16.30

Kissen Room (Room 11) - NIC

Case presentation 5

THE UNNAMED SYMPTOM: A PSYCHOSOMATIC APPROACH

Chair: A. Barbosa (*Portugal*)

Discussants: T. Sivik (*Sweden*)
J. de Figueiredo (*US*)

Speaker: F. Barbosa (*Portugal*)

Thursday, 12th September 2019

17.00-18.30

Auditorium

Symposium 28

PSYCHOSOCIAL PALLIATIVE CARE: OPTIMAL CARE AND STRATEGY IMPLEMENTATION

Chairs: L. Grassi (*Italy*)

P. Leombruni (*Italy*)

17.00 **MANAGING CANCER AND LIVING MEANINGFULLY (CALM)
A PSYCHOTHERAPEUTIC APPROACH TO EARLY PALLIATIVE CARE**

G. Rodin (*Canada*)

17.25 **APPLICATION OF THE ITALIAN MANAGING CANCER AND LIVING
MEANINGFULLY INTERVENTION: PRELIMINARY DATA OF A RAN-
DOMIZED CONTROLLED TRIAL**

R. Caruso (*Italy*)

17.45 **EFFECTS OF THE GERMAN MANAGING CANCER AND LIVING
MEANINGFULLY (CALM) INTERVENTION: A RANDOMIZED, CON-
TROLLED TRIAL**

A. Menhert (*Germany*)

18.10 **PERSONALITY AT THE END-OF-LIFE: THAT'S WHY STUDYING IT**

M. Miniotti (*Italy*)

**Sponsored by World Psychiatry Association (WPA) - Section on Psycho-Oncology
and Palliative Care & World Psychiatry Association (WPA) - Section on Psychiatry,
Medicine & Primary care**

19.30 *CONGRESS DINNER at VILLA FINALY (NOT included in the Main
Conference fee)*

Thursday, 12th September

Thursday, 12th September 2019

16.30-19.00

Aula Magna - NIC

Symposium 29

CULTURA E PRASSI DELLA PSICOSOMATICA: UN TRIBUTO A MASSIMO ROSSELLI

Chairs: A. Minervino (*Italy*)

P.M. Martellucci (*Italy*)

16.30 L'ESPERIENZA DI MASSIMO ROSSELLI NELLA S.I.M.P. E NEL GRUPPO DI RICERCA IN PSICOSOMATICA (GRP)

A. Minervino (*Italy*)

16.45 IFP "MR" PSYCHOSOMATIC TRAINING, STARTING WITH BALINT GROUPS

P.M. Martellucci (*Italy*)

17.00 MAN-MEDICINE IN THERAPEUTIC PSYCHOSINTESIS

A. Toccafondi (*Italy*)

Sponsored by Gruppo di Ricerca in Psicosomatica (GRP), Istituto Formazione Psicosomatica "Massimo Rosselli", Società Italiana di Medicina Psicosomatica (SIMP), Società Italiana di Psicointesi Terapeutica (SIPT)

(In Italian)

Witnesses

Chair: A. Allamani (*Italy*)

17.30 – 18.30 A. Allamani (*Italy*), A. Bonacchi (*Italy*), A. Ciappi (*Italy*), P. Cimbelli (*Italy*), P. Ferrucci (*Italy*), V. Iannuzzi (*Italy*), P.N. Marasco (*Italy*), E. Migliorini (*Italy*), V. Niccolai (*Italy*), S. Seeley Rosselli (*Italy*)

(In Italian)

18.30 – 19.00 Trust Sirigatti Award

19.30 CONGRESS DINNER at VILLA FINALY (NOT included in the Main Conference fee)

Thursday, 12th September 2019

17.00-18.30

Sifneos Room (Room 7) - NIC

Symposium 30

PERSONALITY AND DISEASE

- Chairs:** F. Galli (*Italy*)
V. Lingiardi (*Italy*)
- 17.00 M.R. Bagby (*Canada*)
- 17.25 V. Tesio (*Italy*)
- 17.45 T. Boldrini (*Italy*)
- 18.15 F. Galli (*Italy*)

17.00-18.30

Kellner Room (Room 8) - NIC

Symposium 31

UP-TO-DATE ASPECTS OF MICROBIOME, BRAIN-GUT INTERACTIONS AND IRRITABLE BOWEL SYNDROME

- Chairs:** S. Fukudo (*Japan*)
D. Dumitrascu (*Romania*)
- 17.00 **IMPACT OF STRESS AND GUT MICROBIOTA ON BRAIN-GUT INTERACTIONS IN IRRITABLE BOWEL SYNDROME**
S. Fukudo (*Japan*)
- 17.30 **GUT MICROBIOTA ALTERS STRESS RESPONSE AND BEHAVIOR IN LIVING MAMMALS**
N. Sudo (*Japan*)
- 18.00 **PSYCHOSOMATIC ASPECTS OF IRRITABLE BOWEL SYNDROME**
D. Dumitrascu (*Romania*)
- 19.30 *CONGRESS DINNER at VILLA FINALY (NOT included in the Main Conference fee)*

Thursday, 12th September 2019

17.00-18.30

Lipowski Room (Room 10) - NIC

Symposium 32

BRAIN IMAGING STUDIES IN PSYCHOSOMATIC MEDICINE

- Chairs:** Y. Sato (*Japan*)
K. Yoshihara (*Japan*)
- 17.00 **TWO COMPONENTS IN BODY IMAGE DISTURBANCE ARE ASSOCIATED WITH DIFFERENTIAL NEURAL BASIS**
Y. Hamamoto (*Japan*)
- 17.25 **DYSREGULATION OF DECISION MAKING IN PATIENTS WITH ANOREXIA NERVOSA**
Y. Sato (*Japan*)
- 17.45 **AN IMPORTANT ROLE OF ANTERIOR CINGULATE CORTEX AND INSULA IN MIND-BODY INTERACTION**
K. Yoshihara (*Japan*)
- 18.15 **NEURAL UNDERPINNING OF INTEROCEPTIVE DYSFUNCTION, AND AN EFFECT OF INTEROCEPTIVE TRAINING**
A. Sekiguchi (*Japan*)
- 19.30 *CONGRESS DINNER at VILLA FINALY (NOT included in the Main Conference fee)*

Thursday, 12th September 2019

17.00-18.30

Engel Room (Room 9) - NIC

Symposium 33

FROM BODY TO MIND: A MULTIDISCIPLINARY PERSPECTIVE ABOUT BODY IMAGE IN OBESITY

- Chairs:** M. Zampini (*Italy*)
F. Scarpina (*Italy*)
- 17.00 BODY SIZE ESTIMATION IN OBESITY: A NOVEL INSIGHT FROM THE IMPLICIT / EXPLICIT MODEL OF BODY REPRESENTATIONS
M. Zampini (*Italy*)
- 17.25 THE EFFECT OF A VIRTUAL-REALITY FULL-BODY ILLUSION ON BODY IMAGE IN OBESITY
F. Scarpina (*Italy*)
- 17.45 INTRAPERSONAL, INTERPERSONAL, AND PHYSICAL SPACE IN EATING DISORDERS
C. Malighetti (*Italy*)
- 18.15 DO SUBJECTS WITH OBESITY UNDERESTIMATE THEIR BODY SIZE? A NARRATIVE REVIEW OF ESTIMATION METHODS AND EXPLAINING THEORIES
G. Pietrabissa (*Italy*)
- 19.30 CONGRESS DINNER at VILLA FINALY (NOT included in the Main Conference fee)

Thursday, 12th September 2019

17.00-18.00

Kimball Room (Room 2) - NIC

Workshop 7

CLONAZEPAM TREATMENT OF ATRIAL FIBRILLATION IN PANIC ANXIETY PATIENTS: AN ELEVEN CASE SERIES

Chair: A.E. Nardi (*Brazil*)

Speaker: J.P. Kahn (*US*)

17.00-18.00

Kimball Room (Room 2) - NIC

Case presentation 6

MIGRATION AND PSYCHOSOMATIC IMPACT OF BAD OBSTETRIC HISTORY

Chair: C. Maggioni (*Italy*)

Discussant: G. Desai (*India*)

Speaker: M. Lal (*UK*)

19.30 CONGRESS DINNER at VILLA FINALY (NOT included in the Main Conference fee)



SCIENTIFIC PROGRAMME
FRIDAY

Friday, 13th September 2019



ICPM 2019
www.icpmonline.org

Friday, 13th September 2019

8.00-9.00

Auditorium

Workshop 8

TRANSCULTURAL EASTERN-WESTERN CASE DISCUSSION GROUP

Chair: H.C. Deter (*Germany*)

Speakers: H.C. Deter (*Germany*)
M. Murakami (*Japan*)

8.00-9.00

Aula Magna - NIC

Workshop 9

PRESCRIBING EXERCISE TO OPTIMIZE TREATMENT OUTCOMES: RATIONALE AND STRATEGIES

Speaker: J. Smits (*US*)

8.00-9.00

Sifneos Room (Room 7) - NIC

Workshop 10

JUST USE SAFER (SHORT APPLICATIONS OF FUNCTIONAL AND EMOTIONAL RELAXATION) IN PSYCHOSOMATIC PRIMARY CARE

Chair: T.H. Loew (*Germany*)

Speakers: T.H. Loew (*Germany*)
B. Leinberger (*Germany*)

8.00-9.00

Kellner Room (Room 8) - NIC

Workshop 11

THE VITAL PARENTING TASKS (VPT): PARENT-CHILD PSYCHOTHERAPY FOR CHILDREN AND ADOLESCENTS PRESENTING WITH PSYCHOSOMATIC SYMPTOMS

Speaker: L. Jäderberg (*UK*)

Friday, 13th September 2019

8.00-9.00

Lipowski Room (Room 10) - NIC

Workshop 12

THE PSYCHOSOMATIC FACTORS IN CHRONIC MEDICALLY ILL

Chair: H.C. Deter (*Germany*)

08.00 ASSOCIATION BETWEEN TISSUE FACTOR, OTHER INDICATORS OF THE COAGULATION CASCADE AND DEPRESSION SCALES IN PATIENTS WITH CORONARY ARTERY DISEASE (CAD)

H.C. Deter (*Germany*)

08.30 A BIO-PSYCHO-SOCIAL MODEL OF RESILIENCE IN YOUNG ADULTS NEWLY DIAGNOSED WITH MULTIPLE SCLEROSIS (BPS-ARMS STUDY)

M. Rimondini (*Italy*)

8.00-9.00

Engel Room (Room 9) - NIC

Case presentation 7

CARMEN'S DREAMS. A DYADIC PROCESS AS A CO-CREATIVE EXPERIENCE

Chair: A. Suman (*Italy*)

Discussants: G. Chiarini (*Italy*)
M.R. Zigliani (*Italy*)

Speaker: S. Grassi (*Italy*)

(In Italian)

Friday, 13th September 2019

8.00-9.00

Kimball Room (Room 2) - NIC

Workshop 13

COMPASSION EMBODIED TOOLBOX

Chair: T. Sivik (*Sweden*)

Speaker: E. Bojner Horwitz (*Sweden*)

8.00-9.30

Kissen Room (Room 11) - NIC

Workshop 14

SOMATOSENSORY AMPLIFICATION IN FIBROMYALGIA

8.00 A. Ciaramella (*Italy*)

CONVERTING A PHYSICAL HEALTH CONSULTATION INTO A PSYCHOLOGICAL BASED CONSULTATION

8.30 M. Capek (*UK*)

PROVIDING EFFECTIVE PATIENT-CENTRED CARE THROUGH CLINICAL PSYCHOSO- MATIC METHODS

9.00 M. Lal (*UK*)

Friday, 13th September 2019

09.00-10.30

Auditorium

Update Lecture 3

Chairs: M. Biondi (*Italy*)
V. Starcevic (*Australia*)

THE LOSS OF MEANING IN PSYCHOSOMATIC MEDICINE: CHALLENGES AND SOLUTIONS

Speaker: G. Rodin (*Canada*)

COMPUTER-ASSISTED PSYCHOTHERAPY: CAN COMPUTER TECHNOLOGY ENHANCE TREATMENT DELIVERY?

Speaker: J. Wright (*US*)

09.00-10.30

Aula Magna - NIC

Symposium 34

THE FUTURE OF PSYCHOSOMATIC EDUCATION IN A CHANGING WORLD

Chairs: H. Leigh (*US*)
B. McGee (*US*)

09.00 DOWN-CONTEXTING THE SYMPTOM AND MEDICAL EDUCATION:
BUILDING UP TRUST, FACING PROFESSIONAL LIFE ANEW

W. Schüffel (*Germany*)

09.25 PROMOTION OF THE MENTAL HEALTH OF DOCTORS – ONE OF
THE EDUCATIONAL TASKS IN PSYCHOSOMATICS AND PSYCHO-
THERAPY

G. Ancane (*Latvia*)

09.50 PSYCHOSOMATIC EDUCATION IN UNIFIED FIELD

B.W. Choi (*US*)

10.15 INDIVIDUAL SUPERVISION MODEL IN AN INTEGRATED CARE SET-
TING- PROMISES AND CHALLENGES

B. Nair (*US*)

10.30–11.00 BREAK & POSTER EXHIBITION to Auditorium

Friday, 13th September 2019

09.00-10.30

Sifneos Room (Room 7) - NIC

Symposium 35

NEW FRONTIERS IN THE ASSESSMENT OF EMOTIONAL DYSREGULATION IN PSYCHOSOMATIC DISORDERS

- Chairs:** R.M. Bagby (*Canada*)
F. Baldoni (*Italy*)
- 09.00 **THE MYTH OF ALEXITHYMIA SUBTYPES: A LATENT PROFILE ANALYSIS**
R.M. Bagby (*Canada*)
- 09.25 **EMOTION DYSREGULATION: A CORRELATION NETWORK ANALYSIS**
A. Schimmenti (*Italy*)
- 09.50 **TRAUMA, AUTONOMIC DYSREGULATION AND PSYCHOSOMATIC SYMPTOMS IN PSYCHOTIC DISORDERS**
V. Caretti (*Italy*)
- 10.15 **THE ANALOGICAL SYMPTOM ASSESSMENT (ASA): ITALIAN VALIDATION IN A NON-CLINICAL SAMPLE**
F. Baldoni (*Italy*)
- 10.30–11.00 **BREAK & POSTER EXHIBITION to Auditorium**

Friday, 13th September 2019

09.00-10.30

Kellner Room (Room 8) - NIC

Symposium 36

TRADITIONAL CHINESE MEDICINE IN PSYCHOSOMATIC MEDICINE

Chairs: M.W. Wang (*China*)

C. Kubo (*Japan*)

09.00 **THE SOURCE AND DEVELOPMENT OF PSYCHOSOMATIC MEDICINE OF CHINESE MEDICINE**

P. Zhao (*China*)

09.25 **FIVE TONE THERAPY OF TCM**

Y. Mei (*China*)

09.50 **MODIFIED ERXIAN DECOCTION FOR PERI-MENOPAUSAL DEPRESSION: A RANDOMIZED CONTROLLED CLINICAL TRIAL**

F.Q. Xu (*China*)

10.15 **MITOCHONDRIAL ENERGY METABOLISM DISORDER IN DEPRESSION AND THE REGULATION MECHANISM OF XINGPIJIYU DECOCTION**

R.J. Guo (*China*)

Sponsored by Chinese Society of Preventive Medicine (CSPM)

10.30–11.00 *BREAK & POSTER EXHIBITION to Auditorium*

Friday, 13th September 2019

09.00-10.30

Lipowski Room (Room 10) - NIC

Symposium 37

DIFFERENT APPROACHES TO THE TREATMENT OF PAIN AND SUFFERING

- Chairs:** T. Sivik (*Italy*)
A. Suman (*Italy*)
- 09.00 **DIFFERENT APPROACHES TO THE TREATMENT OF PAIN AND SUFFERING**
T. Sivik (*Sweden*)
- 09.15 **ALEXITHYMIA IN FIBROMYALGIA SYNDROME: ASSOCIATIONS WITH ONGOING PAIN, EXPERIMENTAL PAIN SENSITIVITY AND ILLNESS BEHAVIOR**
A. Suman (*Italy*)
- 09.35 **NARRATIVE SKILLS IN MEDICAL TRAINING: EXPERIENCES OF GENERAL PRACTITIONERS**
G. Chiarini (*Italy*)
- 10.55 **VISUALISATION IN COPING WITH SUFFERING RELATED TO HIV/AIDS DIAGNOSIS**
M.R. Zigliani (*Italy*)
- 10.10 **GROUP HYPNOSIS IN THE TREATMENT OF PSYCHOLOGICAL AND SOMATIC SYMPTOMS IN ADJUSTMENT DISORDER WITH STUDY ABROAD UNIVERSITY STUDENTS**
M.A. Santoro Bellini (*Italy*)
- 10.30–11.00 *BREAK & POSTER EXHIBITION to Auditorium*

Friday, 13th September 2019

09.00-10.30

Engel Room (Room 9) - NIC

Symposium 38

LA RELAZIONE COME FATTORE TERAPEUTICO

Chairs: L. Grassi (*Italy*)

A. Minervino (*Italy*)

09.00 RELATIONAL COMPETENCE

A. Minervino (*Italy*)

09.25 DIGNITY IN CARE

L. Grassi (*Italy*)

09.50 THE NEUROPLASTICITY OF THE SELF IN THE PSYCHOTHERAPEUTIC RELATIONSHIP

M. Farinelli (*Italy*)

10.15 INTERACTIVE BRAINS

L. Fadiga (*Italy*)

Sponsored by Società Italiana di Medicina Psicosomatica (SIMP), Società Italiana di Psichiatria di Consulazione (SIPC), Gruppo di Ricerca in Psicosomatica (GRP), Alta Scuola Italiana per la Lotta allo Stigma (ASILS)

(In Italian)

10.30–11.00 BREAK & POSTER EXHIBITION to Auditorium

Friday, 13th September 2019

09.00-10.30

Kimball Room (Room 2) - NIC

Symposium 39

THE DIAGNOSIS AND TREATMENT OF PSYCHOSOMATIC MEDICINE IN CHINA

- Chairs:** A. Wu (*China*)
Y. Yuan (*China*)
- 09.00 **PSYCHOSOMATIC MEDICINE IN CHINA: PAST, PRESENT AND FUTURE**
A. Wu (*China*)
- 09.25 **APPLICATION OF CHINESE CHARACTERISTIC TREATMENT IN PSYCHOSOMATIC MEDICINE**
Y. Yuan (*China*)
- 09.50 **WILLING ACCEPTANCE AND COMMITMENT THERAPY (WACT)**
D. Yunlong (*China*)
- 10.15 **COGNITIVE BEHAVIOUR THERAPY FOR EMOTIONAL DISORDERS IN ASTHMATIC PATIENTS**
Y. Zhang (*China*)

Sponsored by Chinese Society of Preventive Medicine (CSPM)

09.30-10.30

Kissen Room (Room 11) - NIC

Case presentation 8

RUMINATION-FOCUSED COGNITIVE BEHAVIOUR THERAPY FOR A CASE OF PROBLEMATIC ANGER AND ANGRY RUMINATION: A SINGLE SUBJECT CASE DESCRIPTION

- Chair:** T. Sensky (*UK*)
- Discussants:** E. Tomba (*Italy*)
D. Carrozzino (*Italy*)
- Speaker:** S.B. Møller (*Denmark*)

Sponsored by Gruppo di Ricerca in Psicomatica (GRP)

10.30–11.00 *BREAK & POSTER EXHIBITION to Auditorium*

Friday, 13th September 2019

11.00-12.00

Auditorium

Plenary Lecture 2

CURRENT PERSPECTIVES IN PSYCHOSOMATIC MEDICINE

Chair: K.B. Koh (*Korea*)

Speaker: F. Cosci (*Italy*)

Sponsored by Gruppo di Ricerca in Psicomatica (GRP)

13.00-14.00

Auditorium

Update Lecture 4

Chairs: W. Söllner (*Germany*)

C. Vazquez (*Spain*)

CBASP FOR THE TREATMENT OF PERSISTENT DEPRESSION: PRESENTATION OF THE APPROACH AS WELL AS POSITIVE AND NEGATIVE EFFECTS

Speaker: E.L. Brakemeier (*Germany*)

PSYCHOSOMATIC THEORY OF SCIENCE

Speaker: T. Sivik (*Sweden*)

13.00-14.00

Aula Magna - NIC

Workshop 15

HISTORY OF PSYCHOSOMATIC MEDICINE AS SCIENTIFICALLY BASED MEDICINE IN EUROPE: APPROACHING THE EXPERIENCE

Chair: G. Nasra (*US*)

Speaker: W. Schüffel (*Germany*)

13.00-14.00

Sifneos Room (Room 7) - NIC

MEET THE EDITOR AND THE EDITORIAL OFFICE OF PSYCHOTHERAPY AND PSYCHOSOMATICS

G.A. Fava (*Italy, US*), F. Cosci (*Italy*), E. Tomba (*Italy*)

12.00-13.00 GENERAL ASSEMBLY (for ICPM members only) to Auditorium

12.00-14.00 BREAK LUNCH to Auditorium & POSTER EXHIBITION to Auditorium

Friday, 13th September 2019

13.00-14.00

Kellner Room (Room 8) - NIC

Workshop 16

NEUROMODULATION IN PSYCHOSOMATICS

Chair: Y. Wang (*China*)

Speakers: Y. Wang (*China*)
H. Wang (*China*)
H. Liu (*US*)

13.00-14.00

Lipowski Room (Room 10) - NIC

BOOK PRESENTATION: "PERSON CENTERED APPROACH TO RECOVERY IN MEDICINE"

Editors: L. Grassi (*Italy*), M. Riba (*US*), T. Wise (*US*)

13.00-14.00

Engel Room (Room 9) - NIC

Workshop 17

THE RITUAL CATHARSIS: A CONDITION OF PSYCHIC RESTORE IN DIFFERENT CULTURES

Chair: F. Barbagelata (*Italy*)

13.00 AFRICAN RITUALS

F. Barbagelata (*Italy*)

13.15 TARANTISM

G. Brundusino (*Italy*)

13.30 CATHARSI AND HYPNOSIS

S. Cagiada (*Italy*)

13.45 SCIAMANIC FUSION

G. Colciaghi (*Italy*)

Sponsored by Società Italiana di Medicina Psicوماتica (SIMP)

12.00-14.00 BREAK LUNCH to Auditorium & POSTER EXHIBITION to Auditorium

Friday, 13th September 2019

13.00-14.00

Kimball Room (Room 2) - NIC

Workshop 18

INTEGRATED CARE APPROACHES TO ADDRESSING DEPRESSION IN INDIVIDUALS WITH UNMET SOCIAL NEEDS

Chair: M. Wittink (*US*)

13.00 IMPLEMENTATION OF A COMMUNITY HEALTH WORKER INTERVENTION FOR WOMEN WITH DEPRESSION AND UNMET SOCIAL NEEDS IN WOMEN'S HEALTH PRACTICES

E. Poleshuck (*US*)

13.30 USING PROTECTION ORDERS TO HELP REDUCE HEALTH BURDEN FOR VICTIMS OF VIOLENCE

C. Cerulli (*US*)

13.00-14.00

Kissen Room (Room 11) - NIC

Case presentation 9

"MAYBE THE FOOD, MAYBE MY HEAD": PSYCHOSOMATIC EXPERIENCE, A PARADIGMATIC CLINICAL CASE

Chair: D. Telles-Correia (*Portugal*)

Discussants: E. Fernandes (*Portugal*)

F. Barbosa (*Portugal*)

Speaker: L. Castanheira (*Portugal*)

14.00-15.30

Auditorium

Update Lecture 5

Chairs: E. Silberman (*US*)

J. de Figueiredo (*US*)

TIME FOR REAPPRAISAL: THE USE OF BENZODIAZEPINES IN PSYCHOSOMATIC MEDICINE

Speaker: R. Balon (*US*)

CARDIOVASCULAR PSYCHOSOMATICS

Speaker: C. Rafanelli (*Italy*)

15.30-16.00 BREAK & POSTER EXHIBITION to Auditorium

Friday, 13th September 2019

14.00-15.30

Aula Magna - NIC

Symposium 40

APPLICATION OF YOGA THERAPY IN THE FIELDS OF PSYCHOSOMATIC MEDICINE AND PSYCHIATRY

Chairs: C. Kubo (*Japan*)

K.K. Kimura (*Japan*)

14.00 **INTEGRATIVE MEDICINE AND YOGA THERAPY—THE NEED FOR PSYCHOTHERAPEUTIC YOGA THERAPY**

K.K. Kimura (*Japan*)

14.20 **A CASE OF DRAMATIC IMPROVEMENT IN A PATIENT WITH EATING DISORDER, ALCOHOL ADDICTION, PANIC DISORDER AND BREAST CANCER THROUGH CORRECTION OF THE BUDDHI (INTELLECT) THROUGH YOGA THERAPY**

M. Kamata (*Japan*)

14.40 **CASE STUDY OF PSYCHOTHERAPEUTIC YOGA THERAPY IN A FEMALE PATIENT WHO HAD NO SIGNIFICANT CHANGES WITH PHARMACOTHERAPY OVER A PERIOD OF THREE YEARS**

A. Nakata (*Japan*)

15.00 **YOGA THERAPY FOR THE AUTISM**

A. Choi-Hantke (*Korea*)

Sponsored by Japan Yoga Therapy Society

15.30–16.00 *BREAK & POSTER EXHIBITION to Auditorium*

Friday, 13th September 2019

14.00-15.30

Sifneos Room (Room 7) - NIC

Symposium 41

CLINIMETRIC APPROACH IN THE ASSESSMENT OF EATING DISORDERS: IMPLICATIONS FOR TREATMENT PLANNING

Chairs: E. Tomba (*Italy*)

R. Schumann (*Italy*)

14.00 INTEGRATED PSYCHONUTRITIONAL ASSESSMENT IN EATING DISORDER WITH LIFE TIME TRAUMATIC EXPERIENCES

R. Schumann (*Italy*)

14.20 ASSESSING PARENTAL MOTIVATION FOR CHANGE IN CHILDHOOD OBESITY: THE PURICA-SHORT SCALE

F. Junne (*Germany*)

14.40 IRRATIONAL BELIEFS AND METACOGNITION IN EATING DISORDER OUTPATIENTS

L. Tecuta (*Italy*)

15.00 PSYCHOLOGICAL WELL-BEING AND POSITIVE OUTCOMES IN EATING DISORDERS OUTPATIENTS

E. Tomba (*Italy*)

15.30–16.00 BREAK & POSTER EXHIBITION to Auditorium

Friday, 13th September 2019

14.00-15.30

Kellner Room (Room 8) - NIC

Symposium 42

DIAGNOSIS, COMORBIDITY AND COMPLICATIONS IN SOMATOFORM AND FUNCTIONAL DISORDERS

Chairs: B. Löwe (*Germany*)

W. Söllner (*Germany*)

14.00 THE OFT-OVERLOOKED RISK OF SUICIDE IN SOMATIZATION DISORDERS

J.G. Fiedorowicz (*US*)

14.20 INSONNIA AND SOMATOFORM DISORDER

C. Pieh (*Austria*)

14.40 FUNCTIONAL SOMATIC DISORDERS (FSD) – A NEW COMMON CLASSIFICATION FOR RESEARCH AND CLINICAL USE

P. Fink (*Denmark*)

15.00 FUNCTIONAL SOMATIC SYMPTOMS IN PATIENTS WITH PHYSICAL DISEASES

B. Löwe (*Germany*)

Sponsored by European Association of Psychosomatic Medicine (EAPM)

15.30–16.00 BREAK & POSTER EXHIBITION to Auditorium

Friday, 13th September 2019

14.00-15.30

Lipowski Room (Room 10) - NIC

Symposium 43

FROM PSYCHOSOMATICS TO LIAISON PSYCHIATRY IN RESEARCH AND CLINICAL PRACTICE

- Chairs:** D. Telles-Correia (*Portugal*)
G. Mattei (*Italy*)
- 14.00 PSYCHOSOCIAL PATTERNS STABILITY IN SLE PATIENTS
F. Barbosa (*Portugal*)
- 14.20 COMMON PATHWAYS BETWEEN MOOD, COGNITIVE AND CARDIOVASCULAR DISEASE: CLINICAL EVIDENCES AND PATHOPHYSIOLOGICAL BIOMARKERS
P. Zuzarte (*Portugal*)
- 14.40 POSTOPERATIVE DELIRIUM- AN UPDATE ON CLINICAL FEATURES, NEUROPATHOGENESIS AND MANAGEMENT
C. Alves Moreira (*Portugal*)
- 15.00 CONSULTATION-LIAISON PSYCHIATRY FROM SUB-SPECIALTY TO PROFESSIONAL ATTITUDE: HINTS FROM THE ACTIVITY WITH CANDIDATES TO LIVER TRANSPLANTATION
G. Mattei (*Italy*)
- 15.30–16.00 BREAK & POSTER EXHIBITION to Auditorium

Friday, 13th September 2019

14.00-15.30

Engel Room (Room 9) - NIC

Symposium 44

INSONNIA E CONSEGUENZE IN MEDICINA

Chairs: **A. Minervino** (*Italy*)
C. Simionato (*Italy*)

14.00 **MELATONIN AND INSOMNIA IN ADULTS**

F. Spinogatti (*Italy*)

14.15 **INSOMNIA**

F. Giannetti (*Italy*)

14.30 **INSOMNIA AND SLEEP DISORDERS IN NEUROLOGICAL ILLNESS**

M. Farinelli (*Italy*)

15.50 **INSOMNIA AND CARDIOVASCULAR DISORDES**

M. Carini (*Italy*)

15.05 **INSOMNIA AND METHABOLIC DSEASES**

A. La Russa (*Italy*)

Sponsored by Società Italiana di Medicina Psicosomatica (SIMP)

(In Italian)

15.30–16.00 **BREAK & POSTER EXHIBITION** to Auditorium

Friday, 13th September 2019

14.00-15.30

Kimball Room (Room 2) - NIC

Symposium 45

PSYCHOSOMATIC PRIMARY CARE: EXPERIENCES WITH THE TRANSFER OF ESTABLISHED CONCEPTS TO SITUATIONS UNDER DIFFICULT CIRCUMSTANCES

Chairs: T.H. Loew (*Germany*)

B. Leinberger (*Germany*)

14.00 AN EVALUATION OF A 15 ITEM SCREENING INSTRUMENT FOR PSYCHIC INJURED CHILDREN AND ADOLESCENTS BY TEACHERS AND EDUCATORS

T.H. Loew (*Germany*)

14.20 SANDPLAY WITH PSYCHIC INJURED CHILDREN ASSISTED BY TRAUMAHHELPERS IN INDIA - A TWO YEAR FOLLOW UP

B. Leinberger (*Germany*)

14.40 PROJECT: TRAUMA OPERATORS - ORGANIZED VOLUNTARY: AID FOR CHILDREN WITH A PSYCHIC INJURY CAUSED BY DESASTERS

I. Montanari (*Germany*)

15.00 PREPARE: PREOPERATIVE ANXIETY REDUCTION. PRE-OPERATIVE PSYCHOLOGICAL INTERVENTION TO INCREASE PATIENTS' SELF-EFFICACY IN MANAGING ANXIETY BEFORE MAJOR PANCREATIC SURGERY: PRELIMINARY RESULTS OF A RANDOMIZED CLINICAL TRIAL

L. Del Piccolo (*Italy*)

15.30–16.00 BREAK & POSTER EXHIBITION to Auditorium

Friday, 13th September 2019

14.00-15.30

Kissen Room (Room 11) - NIC

Symposium 46

WELL-BEING AND PSYCHOLOGICAL DISTRESS IN CHRONIC ILLNESS

Chairs: M.G. Nanni (*Italy*)

L. Iani (*Italy*)

14.00 THE EFFECT OF SENSE OF COHERENCE AND POSITIVITY ON SPIRITUAL WELL-BEING AND DISTRESS IN INDIVIDUALS WITH SKIN DISEASES

L. Iani (*Italy*)

14.20 DIGNITY AND SPIRITUALITY IN PATIENTS WITH CHRONIC MEDICAL CONDITIONS

M.G. Nanni (*Italy*)

14.40 THE ROLE OF POSITIVITY ON QUALITY OF LIFE OUTCOMES IN PATIENTS WITH CHRONIC DISEASES

C. Grano (*Italy*)

15.00 SUBCLINICAL DISTRESS AND PSYCHOLOGICAL WELL-BEING AMONG PATIENTS WITH DIFFERENT CHRONIC CARDIAC CONDITIONS

S. Gostoli (*Italy*)

15.30–16.00 BREAK & POSTER EXHIBITION to Auditorium

Friday, 13th September 2019

16.00-17.30

Auditorium

Symposium 47

UPDATE ON BENZODIAZEPINES: NOVEL FINDINGS, OLD CONTROVERSIES

- Chairs:** V. Starcevic (*Australia*)
R. Balon (*US*)
- 16.00 **USE OF BENZODIAZEPINES IN THE MEDICALLY ILL**
R. Balon (*US*)
- 16.20 **LONG-TERM TREATMENT OF PANIC DISORDER WITH BENZODIAZEPINES**
A.E. Nardi (*Brazil*)
- 16.40 **DEPENDENCE AND WITHDRAWAL SYMPTOMS ASSOCIATED WITH BENZODIAZEPINE USE**
V. Starcevic. (*Australia*)
- 17.00 **MYTHS AND REALITIES ABOUT SIDE EFFECTS AND TOLERABILITY OF BENZODIAZEPINES**
E. Silberman (*US*)
- 17.30–18.00 **CLOSING CEREMONY to Auditorium**

Friday, 13th September 2019

16.00-17.30

Aula Magna - NIC

Symposium 48

FROM THE COMMUNITY TO THE BEDSIDE: INNOVATIVE RESEARCH ON DEMORALIZATION

- Chairs:** J.M. de Figueiredo (*US*)
C. Rafanelli (*Italy*)
- 16.00 DEMORALIZATION IN A POPULATION ANTICIPATING REMOVAL FROM THE GAZA STRIP
R. Kohn (*US*)
- 16.20 DEMORALIZATION IN NON-PSYCHOTIC AFFECTIVE DISORDERS
L. Grassi (*Italy*)
- 16.40 DEMORALIZATION IN PARKINSON DISEASE
J. M. de Figueiredo (*US*)
- 17.00 THE EFFECTS OF PSYCHOTHERAPEUTIC SHORT-TERM INTERVENTIONS ON DEMORALIZATION IN PATIENTS WITH ADVANCED CANCER
A. Mehnert-Theuerkauf (*Germany*)
- 17.30–18.00 CLOSING CEREMONY to Auditorium

Friday, 13th September 2019

16.00-17.30

Sifneos Room (Room 7) - NIC

Symposium 49

NEW APPLICATIONS OF WELL-BEING THERAPY

Chairs: G.A. Fava (*Italy, US*)
J.H. Wright (*US*)

- 16.00 **INNOVATIVE STRATEGIES FOR THE ASSESSMENT OF EUTHYMIA**
J. Guidi (*Italy*)
- 16.20 **THE ROLE OF WELL-BEING THERAPY IN TREATMENT OF COUPLES**
E.L. Brakemeier (*Germany*)
- 16.40 **WELL-BEING THERAPY IN THE REHABILITATION SETTING**
B. Nierenberg (*US*)
- 17.00 **NEW PERSPECTIVES FOR WELL-BEING THERAPY IN THE NETHERLANDS**
P. Meulenbeek (*The Netherlands*)
- 17.30–18.00 **CLOSING CEREMONY to Auditorium**

Friday, 13th September 2019

16.00-17.30

Kellner Room (Room 8) - NIC

Symposium 50

BRINGING THE BIOPSYCHOSOCIAL APPROACH INTO THE 21ST CENTURY: COLLABORATION, INTEGRATION, AND TECHNOLOGY

Chairs: S. McDaniel (*US*)
G. Nasra (*US*)

16.00 MODELS OF INTEGRATED CARE AND PSYCHOSOMATIC MEDICINE IN THE DIVISION OF COLLABORATIVE CARE AND WELLNESS (CCW) AT THE UNIVERSITY OF ROCHESTER

G. Nasra (*US*)

16.20 COLLABORATING WITH PATIENTS, FAMILIES, AND HEALTHCARE TEAMS TO PROVIDE BIOPSYCHOSOCIAL CARE: CLINICAL SERVICE AND TRAINING MODELS

T. Rosenberg (*US*)

16.40 TREATING MIND AND BODY THROUGH WHILE BEING HOSPITALIZED AT UPMC: iMIPS AND PRIME MEDICINE PROGRAMS

H.B. Lee (*US*)

17.00 USING TECHNOLOGY TO SUPPORT COLLABORATIVE APPROACHES TO PSYCHIATRIC PROBLEMS IN RURAL AREAS

J. Richman (*US*)

17.30-18.00 CLOSING CEREMONY to Auditorium

Friday, 13th September 2019

16.00-17.30

Lipowski Room (Room 10) - NIC

Symposium 51

TREATMENT OF PATIENTS WITH EATING DISORDERS USING CBT-E/CBT-OB IN THE REAL-WORLD SETTINGS IN JAPAN AND ITALY

- Chairs:** K. Yoshiuchi (*Japan*)
R. Dalle Grave (*Italy*)
- 16.00 USING SHORT-TERM INPATIENT SETTINGS MODIFYING THE MULTISTEP CBT-E TO INTRODUCE CBT-E SMOOTHLY FOR EATING DISORDER PATIENTS IN JAPAN
K. Yoshiuchi (*Japan*)
- 16.20 CHANGING CARE SETTINGS RELATED TO EATING DISORDERS IN JAPAN
S. Takakura (*Japan*)
- 16.40 PRESURGICAL PSYCHOSOCIAL EVALUATION AND POSTSURGICAL PSYCHOSOCIAL CARE OF BARIATRIC SURGERY PATIENTS BY PSYCHOSOMATIC INTERNIST IN JAPAN
T. Yamazaki (*Japan*)
- 17.00 IMPLEMENTING EVIDENCE-BASED PSYCHOLOGICAL TREATMENTS FOR EATING DISORDERS AND OBESITY IN A REAL-WORLD CLINICAL SERVICE
R. Dalle Grave (*Italy*)
- 17.30–18.00 CLOSING CEREMONY to Auditorium

Friday, 13th September 2019

16.00-17.30

Engel Room (Room 9) - NIC

Symposium 52

DETERMINANTS AND TRAJECTORIES OF SOMATOFORM AND FUNCTIONAL DISORDERS

Chairs: P. Fink (*Denmark*)

B. Löwe (*Germany*)

16.00 MISSED SOMATIC DIAGNOSIS, ADVERSE CHILDHOOD EXPERIENCES (ACE), CHILDHOOD SEXUAL ABUSE AND TREATMENT OUTCOME IN CONVERSION DISORDER(CD). A CLINICAL EPIDEMIOLOGICAL STUDY

C. van der Feltz-Cornelis (*UK*)

16.20 NETWORK APPROACH OF EMOTION AND BODILY SYMPTOM DYNAMICS IN RELATION TO CHILDHOOD ADVERSITY IN PATIENTS WITH IRRITABLE BOWEL SYNDROME AND COMORBID PANIC DISORDER

C. Leue (*The Netherlands*)

16.40 COURSE AND PREDICTORS OF DSM-5 SOMATIC SYMPTOM DISORDER IN PATIENTS WITH VERTIGO AND DIZZINESS SYMPTOMS

C. Lahmann (*Germany*)

17.00 WHAT FACTORS ARE ASSOCIATED WITH THE TIME PATIENTS WITH SOMATIC SYMPTOM DISORDER DEVOTE TO THEIR PHYSICAL AILMENTS? A MULTIPLE REGRESSION ANALYSIS

S. Kohlmann (*Germany*)

IRRITABLE BOWEL SYNDROME, FIBROMYALGIA, CHRONIC FATIGUE SYNDROME AND RELATED SYNDROMES ARE PREVALENT AND HIGHLY OVERLAPPING IN THE GENERAL POPULATION. DanFunD

M.W. Petersen (*Denmark*)

Sponsored by European Association of Psychosomatic Medicine (EAPM)

17.30–18.00 CLOSING CEREMONY to Auditorium

Friday, 13th September 2019

16.00-17.30

Kimball Room (Room 2) - NIC

Symposium 53

PERSPECTIVES IN PSYCHOSOMATIC MEDICINE - INTEGRATION THROUGH INTERACTION AND NETWORKING

Chairs: H.C. Deter (*Germany*)
C. Kubo (*Japan*)

Discussant: H. Leigh (*US*)

16.00 **ORIGIN, AIMS AND PROGRESS OF THE ASIAN COLLEGE OF PSYCHOSOMATIC MEDICINE**

C. Kubo (*Japan*)

16.20 **AIMS AND PROGRESS OF THE EUROPEAN NETWORK ON PSYCHOSOMATIC MEDICINE**

H.C. Deter (*Germany*)

16.40 **EMOTIONAL REGULATION IN HEALTH AND IN DISEASE**

R. Verissimo (*Portugal*)

17.00 **AFFIRMING THE IMPORTANCE OF PSYCHOSOMATIC MEDICINE IN THE MANAGEMENT OF THE CHRONIC DIGESTIVE DISEASES**

D. Dumitrascu (*Romania*)

17.30–18.00 **CLOSING CEREMONY to Auditorium**

Friday, 13th September 2019

16.00-17.30

Kissen Room (Room 11) - NIC

Symposium 54

THE DIVERSITY OF CLINICAL PSYCHOSOMATIC MEDICAL PRACTICE

- Chair: M. Lal (*UK*)
V. Dorairaj (*India*)
- 16.00 CURTAILING UNETHICAL PRACTICES IN WOMEN'S HEALTHCARE
M. Lal (*UK*)
- 16.25 PSYCHOSOMATIC APPROACHES TO REHABILITATION IN CASES OF REFRACTORY PARAPLEGIA
V. Dorairaj (*India*)
- 16.50 PTSD AFTER CHILDBIRTH; A COMMON UNDER-ESTIMATED PROBLEM IN EARLY POSTPARTUM
C. Maggioni (*France*)
- 17.15 THE IMPACT OF SOCIAL ENVIRONMENT ON PSYCHOSOMATIC HEALTH CONDITIONS
M. Lal (*UK*)
- 17.30–18.00 CLOSING CEREMONY to Auditorium



POSTER PROGRAMME



ICPM 2019
www.icpmonline.org

Wednesday, 11th September 2019

12.00-19.30

AUDITORIUM HALL

Poster num. on the poster board	Poster code	Title	Authors
1	P1	Brain functional connectivity in patients with somatic symptom disorder: a pilot study	Sun Mi Kim, Doug Hyun Han, Ji Sun Hong, Heejin Kim, Ki-Hyeon Kwak, Naryoung Kim, Yoon Kyung Heo
2	P2	Reflective functioning in patients with irritable bowel syndrome	Larisa Dzirlo, Felix Richter, Henriette Löffler-Stastka
3	P3	Psychosomatic Dysregulation as a mediator within the relation between cognitive disturbances and psychosomatic symptom in an adolescents' group for at-risk psychotic onset	Giulia Lanza di Scalea, Lucrezia Trani, Anna Laura Amato, Renato Carpentieri, Grazia Terrone, Vincenzo Caretti
4	P4	The association between somatic symptoms and brain connectivity within default mode network in children with attention deficit hyperactivity disorder	Heejin Kim, Sun Mi Kim, Doug Hyun Han, Ji Sun Hong, Hye Ri Kim, Ki-Hyeon Kwak
5	P5	Semiotic Network Analysis: modelling patient cognition and behavior vis-à-vis therapy choice	Szilvia Zörgő, Gjalt-Jorn Ygram Peters
6	P6	The incremental validity of cognitive defusion and flexible present-focused attention in predicting adjustment to chronic pain	Mery Paroli, Olivia Bernini, Cristina Belviso, Carmen Berrocal
7	P7	Spatiotemporal differences of gastric electrical activity in patients with chronic nausea and vomiting syndrome	Tomotaka Shoji, Yuka Endo, Yasuhiro Satoh, Daisaku Tamura, Yuhei Yamaguchi, Shin Fukudo
8	P8	Effectiveness of preventing depressive emotion by changing their cognition for education students	Kumiko Yoshitake, Etsuko Hayashi, Maori Urakawa, Maki Nakamura
9	P9	Altered resting-state brain activities in subcortical vascular Mild Cognitive Impairment (svMCI): dissociation of different Chinese medicine patterns	Jianjun Wang, Haotao Zheng, Jianxiang Chen, Jinyun Gao, Liuchang Zhou, Songjun Lin, Fanxin Kong, Zhouke Guo
10	P10	Effects of pre-sleep cognitive intrusions on subjective sleep and next-day executive performance in insomnia disorder	Andrea Balleisio, Valerio Ghezzi, Mariacarla Vacca, Cristina Ottaviani, Caterina Lombardo

Wednesday, 11th September 2019

12.00-19.30

AUDITORIUM HALL

Poster num. on the poster board	Poster code	Title	Authors
11	P11	Emotion regulation moderates the relationship between insomnia and depression	Andrea Ballesio, Fabio Lucidi, Caterina Lombardo
12	P12	An investigation concerning the taste sensitivity between the eating disorder patients and the healthy people	Chiemi Nakamoto, Reiko Matsumoto, Fujiko Konjiki, Yutaka Suzuki
13	P13	The self dialogue for being mindful: the dyadic process of emotion regulation	Chui-De Chiu, Pak Kwan Lo, Hiu Ching Siu
14	P14	Psyche to soma: evidences for a mood-brain-heart continuum	Pedro Zuzarte, Kary Kostiw, Luisa Figueira, Ana Andrezza, Atilio Costa-Vitali
15	P15	The role of brain entropy on antidepressant effect in major depressive disorder	Xiaoyun Liu, Donghui Song, Yingying Yin, Chunming Xie, Haisan Zhang, Hongxing Zhang, Zhijun Zhang, Ze Wang, Yonggui Yuan
16	P16	Burnout, suicidal ideation and depressive symptoms among nurse students in Modena	Silvia Ferrari, Andrea Pascucci, Luca Pingani, Giuliana Del Prete, Paola Ferri
17	P17	Process of dealing with stress of husbands providing care for dementia afflicted wives — male caregivers in Japan	Takako Negishi, Chieko Kato, Sayaka Kon
18	P18	A single session of the integrated yoga program as a stress management education for school staff employees: the effect of practicing by themselves on the daily practitioners vs non-daily practitioners	Michiyo Nosaka, Hitoshi Okamura
19	P19	Comparing the contribution of psychological inflexibility and coping measures to explain adjustment to cancer	Cristina Belviso, Clizia Cincida, Olivia Bernini, Mery Paroli, Carmen Berrocal
20	P20	A case study using yoga for athletes' mental training -the case of baseball players	Yukiko Kezuka, Chieko Kato
21	P21	Factors relating caregiver's preference for patients' advance care planning in Japan	Fumio Shaku, Shoko Kotera, Shuichiro Maruoka

Wednesday, 11th September 2019

12.00-19.30

AUDITORIUM HALL

Poster num. on the poster board	Poster code	Title	Authors
22	P22	Investigation on preventing stressed teachers to leave their jobs in pre-school in Japan	Etsuko Hayashi, Kumiko Yoshitake, Maki Nakamura, Maori Urakawa
23	P23	Effective strategies to reduce teachers' school stress in Japan: in the view point of changing their own cognition	Maori Urakawa, Maki Nakamura, Etsuko Hayashi, Kumiko Yoshitake
24	P24	Effectiveness of a brief training program in relational/communication skills for medical residents	Miguel Barbosa, Lidia Del Piccolo, António Barbosa
25	P25	Excessive belching successfully treated with psychodynamic psychotherapy: a case report	Beatriz Ayllón Martín
26	P26	Are romantic attachment and couple relational characteristics predictive of Assisted Reproductive Treatment positive outcomes?	Alessia Renzi, Michela Di Trani, Luigi Solano, Cinzia Di Monte, Renata Tambelli
27	P27	Is parental solicitousness correlated with bowel symptoms in adolescent?	Yuka Endo, Tomotaka Shoji, Motoyori Kanazawa, Daisaku Tamura, Yasuhiro Sato, Yuhei Yamaguchi, Shin Fukudo
28	P28	The role of perceived stress in prenatal affective disorders and couple adjustment: an interdependence model	Franco Baldoni, Michele Giannotti, Valerio Luperini, Mattia Minghetti, Nicola Ambrogetti, Simone Peverieri, Federico Spelzini
29	P29	Play experiences promote resilience and stress tolerance	Hisami Hashimoto, Masaya Hisamura
30	P30	Improving well-being and acceptance in people with paranoid tendencies; a study of the effectiveness of a group intervention with ESM data	Regina Espinosa, Carmen Valiente, Alba Contreras, Almudena Trucharte, Borja Paredes, Vanesa Peinado
31	P31	Determinants of well-being and life satisfaction among individuals with severe mental illness: an integrated investigation	Alba Contreras, Rocio Caballero, Regina Espinosa, Almudena Trucharte, Vanesa Peinado, Carmen Valiente

Wednesday, 11th September 2019

12.00-19.30

AUDITORIUM HALL

Poster num. on the poster board	Poster code	Title	Authors
32	P32	Promoting mental health and well-being in early adolescence through a resilience-based programme	Valeria Donisi, Sara Carbone, Silvia Rizzi, Stefano Forti, Silvia Gabrielli, on behalf of the UP-RIGHT Consortium
33	P33	Aspects related to negative affectivity in adults	Juliana Alvares Duarte Bonini Campos, Fernanda Salloume Sampaio Bonafé, Bianca Gonzalez Martins, Lucas Arrais de Campos, João Maroco
34	P34	Contribution of orofacial aesthetics to satisfaction with life	Lucas Arrais de Campos, Ary dos Santos Pinto, João Marôco, Juliana Alvares Duarte Bonini Campos
35	P35	Examining depression and anxiety during school refusal: interviews with adults who experienced school refusal during adolescence	Yoko Niikawa, Chikaze Sugiyama, Makoto Kumagai, Taisuke Katsuragawa, Hiroaki Kumano, Shunsuke Koseki
36	P36	Well-Being Therapy and the promotion of lifestyle changes in metabolic syndrome: a case report	Giada Benasi, Jenny Guidi, Chiara Rafanelli, Giovanni Andrea Fava
37	P37	Web-based Acceptance and Commitment Therapy program to improve psychological well-being for working mothers with pre-school child: A protocol for randomized controlled trial	Natsu Sasaki, Kotaro Imamura, Norito Kawakami
38	P38	Associations between social support, study engagement, and mental health outcomes in Japanese undergraduate students: A cross-sectional study	Masanori Tanaka, Jun Tayama, Akihito Shimazu
39	P39	A retrospective study of patients with somatic symptom disorder	Bo Qianlan, Wang Mingwei
40	P40	The difference in the clinical characteristics of unilateral Oral Dysesthesia patients with or without trigeminal Neurovascular Compression	Kazuya Watanabe, Trang T.H Tu, Lou Mikuzuki, Kaoru Kawasaki, Shiori Sugawara, Takayuki Suga, Chaoli Hong, Asami Mitsuhiro, Takeshi Watanabe, Miho Takenoshita, Akira Toyofuku

Wednesday, 11th September 2019

12.00-19.30

AUDITORIUM HALL

Poster num. on the poster board	Poster code	Title	Authors
41	P41	Prenatal psychological distress and the risk of pre-eclampsia - the Finn-Brain Birth Cohort Study	Linnea Karlsson, Eeva Ekholm, Riikka Korja, Noora M Scheinin, Hasse Karlsson
42	P42	Effects of lifestyle intervention on psychological distress and wellbeing in obese patients: a single-group prospective observational study	Boheng Zhu, Sara Gostoli, Giada Benasi, Grazia Galli, Guilio Marchesini Reggiani, Chiara Rafanelli
43	P43	Risk and protective factors of hypertension among people with neuroticism trait	Jun Otonari, Nobuyuki Sudo
44	P44	Too low or too high psychological well-being as risk factor for binge drinking in 14 years old students: a multivariate logistic regression study	Luana Fantini, Sara Gostoli, Sara Casadei, Veronica A. De Angelis, Chiara Rafanelli
45	P45	Exposure to maternal prenatal psychological distress is associated with wheezing at child age 24 months	Emma Puosi, Linnea Karlsson, Heikki Lukkarinen, Hasse Karlsson, Minna Lukkarinen
46	P46	Inner dialogue, intensification of psychosomatic symptoms and acceptance of disease	Agata Banakiewicz, Agnieszka Kulik
47	P47	Shifting the paradigm – maternal distress symptoms during pregnancy are associated with the offspring food allergy/intolerance at 6 months	Minna Lukkarinen, Emma Puosi, Eeva-Leena Kataja, Laura S. Korhonen, Heikki Lukkarinen, Linnea Karlsson, Hasse Karlsson
48	P48	Beyond internalized and externalized behaviors: The unique role of dissociation in relational difficulties among children in residential care service	Wing-Ki Kwok, Chui-De Chiu
49	P49	DL-3-n-butylphthalide improves cognitive impairment in SAMP8 mice: involvement of Nrf2 and synaptic plasticity	Chaonan Lv, Bing Han, Zhongxia Zhang, Xiaoman Zhang, Jing Li, Mingwei Wang
50	P50	Metabolic, serologic, atherogenic and psychological factors associated with the presence of colorectal precancerous lesions: a cross-sectional study in a psycho-neuro-endocrine-immunological (PNEI) perspective	Giorgio Mattei, Giulia Rioli, Mattia Marchi, Andrea Sacchetti, Stefano Mancini, Silvia Alboni, Luca Roncucci, Paola Sena, Silvia Ferrari

Wednesday, 11th September 2019

12.00-19.30

AUDITORIUM HALL

Poster num. on the poster board	Poster code	Title	Authors
51	P51	Correlation between neurotransmitter marker and oxidative stress marker in urine organic acid test	Eunhye Kim, Paul Han, Sat Byul Park
52	P52	Effects of tapping touch on changes in oxytocin concentration in saliva part 1	Yoshikazu Fukui, Shin-ichi Oura, Ichiro Nakagawa, Yoshiko Nakagawa
53	P53	Effects of tapping touch on changes in oxytocin concentration in saliva part 2: the difference depending on attachment style	Shin-ichi Oura, Yoshikazu Fukui, Ichiro Nakagawa, Yoshiko Nakagawa
54	P54	On the change of salivary α -amylase level in a student of early childhood education during a childcare internship	Takao Miyazaki
55	P55	Risky levels of biomarkers associated with minor depression and demoralization among patients with a first episode of acute coronary syndrome	Luana Fantini, Sara Gostoli, Chiara Rafanelli
56	P56	Robust stability and physiological correlates of infants' patterns of regulatory behavior in the still-face paradigm at 3 and 9 months	Miguel Barbosa, Marjorie Beeghly, João Moreira, Edward Tronick, Marina Fuentes
57	P57	Predicting patterns of regulatory behavior in the Still-Face Paradigm at 3 months	Miguel Barbosa, Marjorie Beeghly, João Moreira, Edward Tronick, Marina Fuentes
58	P58	Infants' physiological responses during the FFSF at 3 months according to the patterns of attachment at 12 months	Miguel Barbosa, Marjorie Beeghly, João Moreira, Edward Tronick, Marina Fuentes
59	P59	Interest in religion, spirituality and spiritually integrated psychotherapy among Brazilian depressed patients	Bruno Paz Mosqueiro, Mateus Messinger, Felipe Bauer, William Barcelos, Mariana Uequet, Gabriela Possebon, Marco Antonio Caldieraro, Marcelo Pio de Almeida Fleck

Thursday, 12th September 2019

9.00-19.00

AUDITORIUM HALL

Poster num. on the poster board	Poster code	Title	Authors
1	P60	Acute effect of body-mind practices and circuit training on instantaneous wellbeing in inpatients with major depressive episode	Torelly Gabriela, Schuch Felipe, Cardoso Caren, Konig Augusto, Fleck Marcelo
2	P61	Portal hypertension in prolonged anorexia nervosa with laxative abuse	Keisuke Kawai, Aiko Koga, Sun-ao Matsuubayashi, Masayasu Shoji, Naho Tamura
3	P62	Heart rate variability of PTSD patients in trauma-related words condition: a preliminary study	Misari Oe, Tetsuya Ishida, Shintaro Fujimoto, Takahiro Urasaki, Naohisa Uchimura
4	P63	Psychiatric morbidity and sleeping disorders in psychodermatologic patients	Haiping Zhang, Yidan Zhang, Yuting Zhang, Fei Sun
5	P64	Pattern Separation performance in Obsessive Compulsive Disorder	Giovanni Mansueto, Umberto Albert, Claudia Cumerlato Melter, Giuseppe Maina, Giulia Aldi
6	P65	Characteristics of eating behavior among people with typical and atypical depression	Takeaki Takeuchi, Kazuaki Hashimoto, Kazushige Ihara, Shuichi Obuchi, Hirohio Hirano, Yoshinori Fujiwara, Hisashi Kawai, Motonaga Kojima, Masahiro Hashizume
7	P66	Clinical and economic outcomes of remotely delivered cognitive behaviour therapy for repeat unscheduled care users with severe health anxiety: a multi-centre randomised controlled trial	Richard Morriss, Shireen Patel, Sam Malins, Boliang Guo, Fred Higton, Marilyn James, Mengjun Wu, Paula Brown, Naomi Cope, Catherine Kaylor-Hughes, Emma Rowley, Martin Morris, Jayne Simpson, David Smart, Michelle Stubley, Helen Tyrer, Joe Kai
8	P67	Posttraumatic stress disorder in medical populations: Systematic literature review	Samuel Cyr, De Xuan Guo, Valerie Long, Sylvie Lévesque, Laurence Jobidon, Katia Dyrda, Judith Brouillette
9	P68	Anti-social behaviors observed in Prader- Willi syndrome: a case report and literature review	Yohei Suzuki, Satoshi Kato

Thursday, 12th September 2019

9.00-19.00

AUDITORIUM HALL

Poster num. on the poster board	Poster code	Title	Authors
10	P69	Effects of trauma and abuse in anti-social personality disorder and substance use disorders	J. Azevedo, M. Castelo-Branco, R. Coelho, M. Figueiredo-Braga
11	P70	An investigation of behavioral factors influencing elderly anorexia nervosa	Takayuki Ueno, Yuzo Nakamura, Hideyuki Imamura, Jun Miyakoda, Takeaki Takeuchi, Masahiro Hashizume
12	P71	Medical hypnosis as an effective intervention against test anxiety in first year medical students	Christian M. Hammer, Michael Scholz, Larissa Bischofsberger, Friedrich Paulsen, Pascal H.M. Burger
13	P72	Effectiveness of yoga as mental training	Sachiko Kato
14	P73	The self-regulation of alexithymia: chronic self-regulatory modes influence alexithymia through mindfulness	Idit Shalev
15	P74	The effect of omega-3 fatty acids for depressive symptoms among pregnant women in Japan and Taiwan: A randomized, double-blind, placebo-controlled trial and biomarker study	Daisuke Nishi, Kuan-Pin Su, Kentaro Usuda, Jane Pei-Chen Chang, Kei Hamazaki, Tamaki Ishima, Kenji Hashimoto, Yutaka J. Matsuoka
16	P75	12-month follow-up of the U-CARE Heart Trial: using internet-based cognitive behavioural therapy to treat patients experiencing depression and anxiety after myocardial infarction	Sophia Monica Humphries, John Wallert, Fredrika Norlund, Claes Held, Erik Olsson
17	P76	Suicide attempts are predicted by severity of substance use disorders	J. Azevedo, M. Castelo-Branco, R. Coelho, M. Figueiredo-Braga
18	P77	Influence of negative affectivity and body mass index on eating behavior	Juliana Alvares Duarte Bonini Campos, Bianca Gonzalez Martins, Wanderson Roberto da Silva, João Maroco
19	P78	Long-term effects of group cognitive behavioral therapy for depression prevention in first-year university students	Kiriko Yanai, Sayaka Ogawa, Masaki Hayashida, Jun Tayama, Tatsuo Saigo, Peter Bernick, Susumu Shirabe

Thursday, 12th September 2019

9.00-19.00

AUDITORIUM HALL

Poster num. on the poster board	Poster code	Title	Authors
20	P79	Short-term mindfulness based psycho-education and practice improves posttraumatic stress reaction and mental health in Japanese	Daisuke Ito, Yuki Kubo, Ayako Takii, Asuka Watanabe, Chikaze Sugiyama, Shunsuke Koseki, Shin-ichi Suzuki
21	P80	Illness anxiety disorder and anorexia nervosa comorbidity: is it an atypical form of eating disorder?	Lígia Castanheira, Elsa Fernandes, Mariana Melo, Lara Castro Nunes, Filomena Sequeira, Sílvia Neves, Irene Lopes, Jennifer Santos, António Neves
22	P81	The impact of personality dimension in patients with medically unexplained oral symptoms	Trang T.H Tu, Lou Mikuzuki, Kaoru Kawasaki, Shiori Sugawara, Takayuki Suga, Chaoli Hong, Asami Mitsuhoro, Takeshi Watanabe, Miho Takenoshita, Akira Toyofuku
23	P82	Long-term transition of PTSD and depression symptoms on high school students in the affected area of the Great East Japan Earthquake	Shunsuke Koseki, Chikaze Sugiyama, Yoko Niikawa, Daisuke Ito, Mami Koseki, Shin-ichi Suzuki
24	P83	The effects of behavioral activation approach on depression among students affected by the Great East Japan Earthquake	Chikaze Sugiyama, Kana Fujino, Yoko Niikawa, Kotomi Sugawa, Ayako Takii, Daisuke Ito, Mami Koseki, Shin-ichi Suzuki, Shunsuke Koseki
25	P84	Stress and mental health in children with Autism Spectrum Disorder (ASD): considerations through application of group psychotherapy	Maki Nakamura, Maori Urakawa, Kumiko Yoshitake, Etsuko Hayashi
26	P85	Effectiveness of behavioral activation therapy for anxiety in Japanese cancer patients: a retrospective study	Takatoshi Hirayama, Yuko Ogawa, Yuko Yanai, Akie Shindo, Shin-ichi Suzuki, Ken Shimizu
27	P86	Connection with People Experienced by People with Hikikomori Experience	Mamoru Naito, Masako Saito, Keiko Nakamura, Seiko Tanabe, Rie Kobayashi
28	P87	ICU delirium can be a predictor of nighttime emergencies on general wards after ICU discharge	Yoko Ichiki, Ui Yamad, Sachiko Ohde, Daisuke Ohta

Thursday, 12th September 2019

9.00-19.00

AUDITORIUM HALL

Poster num. on the poster board	Poster code	Title	Authors
29	P88	Novel psychotherapeutic approach in the treatment of Takotsubo syndrome	Leonarda Galiuto, Annamaria Mandese, Piero Petrini, Luigi Janiri
30	P89	Aspects of the experience of the representative of Hikikomori parents' committee	Masako Saito, Keiko Nakamura, Mamoru Naito, Seiko Tanabe, Rie Kobayashi
31	P90	Actual status of Hikikomori support by public health nurses working for administrative organizations in Niigata prefecture	Seiko Tanabe, Keiko Nakamura, Masako Saito, Mamoru Naito, Rie Kobayashi
32	P91	Autism tendency of patients with symptoms of hypersomnia	Reiko Hori, Maiko Suda, Ryuji-ro Sasanabe, Toshiaki Shiomi
33	P92	A case study on halitophobia with oral dysesthesia treated with low-dose aripiprazole	Miho Takenoshita, Tu T H Trang, Shiori Sugawara, Kaoru Kawasaki, Takayuki Suga, Kazuya Watanabe, Chaoli Hong, Yuka Sakuraba, Lou Mikuzuki, Takeshi Watanabe, Akira Toyofuku
34	P93	Influence of change in intolerance of uncertainty on patient's evaluation and dentist's evaluation of symptom in burning mouth syndrome	Hirofumi Matsuoka, Masafumi Utsunomiya, Koki Yoshida, Yuji Sakano, Yoshihiro Abiko, Itsuo Chiba
35	P94	Treatment of osteoporosis with Teriparatide in anorexia nervosa patients	Toshie Sasaki, Takao Kodama, Chiemi Nakamoto, Yutaka Suzuki
36	P95	Evidence for an enhanced procoagulant state in remitted major depression	Roland von Känel, Franziska Merz, Hildegard Pfister, Tanja Brückl, Petra Zimmermann, Manfred Uhr, Florian Holsboer, Nina Höhne, Marcus Ising
37	P96	The post-traumatic stress disorder in an informal caregiver: a clinical case	Gloria Leonardi, Erik Bertoletti, Marina Farinelli

Thursday, 12th September 2019

9.00-19.00

AUDITORIUM HALL

Poster num. on the poster board	Poster code	Title	Authors
38	P97	Correlates of exercise and sport participation in Brazilians outpatients with major depressive disorder	Fernanda Castro Monteiro, Felipe Barreto Schuch, Bruno Paz Mosqueiro, Mateus Frizzo Messinger, Joyce Santos do Amaral, Mariana de Medeiros Ueque, Marco Antonio Knob Caldieraro, Marcelo Pio de Almeida Fleck
39	P98	Perceived barriers, benefits and correlates to physical activity in outpatients with major depressive disorder	Fernanda Castro Monteiro, Felipe Barreto Schuch, Joyce Santos do Amaral, Bruno Paz Mosqueiro, Mateus Frizzo Messinger, William Barcelos, Marco Antonio Knob Caldieraro, Marcelo Pio de Almeida Fleck
40	P99	The effects of integrated hospital treatment for anorexia nervosa: a longitudinal resting-state functional MRI study	Motoharu Gondo, Keisuke Kawai, Yoshiya Moriguchi, Akio Hiwatashi, Shu Takakura, Kazufumi Yoshihara, Chihiro Morita, Makoto Yamashita, Sanami Eto, Nobuyuki Sudo
41	P100	Assessing alexithymia: the first application of TSIA on obese patients	Cinzia Di Monte, Alessia Renzi, Luigi Solano, Gianfranco Silecchia, Emanuela Paone, Michela Di Trani
42	P101	Comparison of cause of death in inpatients with schizophrenia and organic mental disorders: a survey of 20 years in a psychiatric hospital	Kengo Sato
43	P102	Hikikomori supporter's experience	Keiko Nakamura, Masako Saito, Mamoru Naito, Seiko Tanabe, Rie Kobayashi
44	P103	Struggling back to the self, even with one more step: Perspective shifting, emotion sharing, and borderline personality disorder	Hau Ching Ng, Hiu Wing Sharon Wong, Chuk Nga Lana Lam, Yuk Lan Yvonne Chui, Suk Bik Brenda Lam, Suk Yi Sonia Chang, Heung Chuen George Chong, Chui-De Chiu

Thursday, 12th September 2019

9.00-19.00

AUDITORIUM HALL

Poster num. on the poster board	Poster code	Title	Authors
45	P104	The effects of Tapping Touch on self-compassion	Ichiro Nakagawa, Shin-ichi Oura, Yoshikazu Fukui, Yoshiko Nakagawa
46	P105	The art of predicting treatment outcome in obsessive-compulsive disorder: effectiveness and its predictors in routine clinical care	Philipp Herzog, Ulrich Voderholzer, Matthias Feldmann, Winfried Rief, Eva-Lotta Brake-meier
47	P106	Somatic symptoms, risky behaviors and addictions in fathers evaluated by the Perinatal Assessment of Paternal Affectivity (PAPA)	Franco Baldoni, Roberta Mandolesi, Mattia Minghetti, Francesca Agostini, Nicola Ambrogetti, Simone Peverieri, Valerio Luperini, Licia Massa, Federico Spelzini
48	P107	Increased somatic symptoms in vascular cognitive impairment patients with subthreshold depression: implications from Chinese medicine syndrome differentiation	Jianjun Wang, Songjun Lin, Xiude Qin, Haotao Zheng, Fanxin Kong, Xuan Liu, Zhouke Guo
49	P108	Anxiety and placebos without deception: Open-label placebos reduce test anxiety and improve self-management skills - a randomized controlled trial	Michael Schaefer, Rebecca Harke, Nina Olk, Merve Erkovan, Claudia Denke, Sören Enge
50	P109	Autonomic deficits and psychosomatic dysregulation in a group of adolescents at high risk of psychosis	Giulia Lanza di Scalea, Camilla Guccione, Marianna Ambrosecchia, Adriano Schimmenti, Vincenzo Caretti
51	P110	Experiences of aged parents supporting their long-term Hikikomori child	Rie Kobayashi, Masako Saito, Keiko Nakamura, Mamoru Naik to, Seiko Tanabe
52	P111	Heart rate variability in individuals with somatization diagnoses: the effects of somatic symptom disorder and persistent somatization	Wei-Lieh Huang, Cheryl C. H. Yang, Terry B. J. Kuo, I-Ming Chen, Tzu-Ting Chen, Shih-Cheng Liao, Susan Shur-Fen Gau
53	P112	Somatization and DCPR in psychotic patients	Nilüfer Sayilgan

Thursday, 12th September 2019

9.00-19.00

AUDITORIUM HALL

Poster num. on the poster board	Poster code	Title	Authors
54	P113	Are experiences of childhood maltreatment in elderly patients with mental disorders connected with current interpersonal problems?	Simon Bollmann, Thomas Gärtner, Maxim Zavorotny, Eva-Lotta Brakemeier
55	P114	The role of hair cortisol concentration in the association between parent and child psychopathology: a sex-based analysis	Mark A. Ferro, M. Claire Buchan, Andrea Gonzalez
56	P115	Interstitial Cystitis/Bladder Pain Syndrome and quality of life: cross-sectional study on Italian women	Dina Di Giacomo, Jessica Ranieri, Federica Guerra
57	P116	Catastrophizing in individuals with different pain characteristics	Lucas Arrais de Campos, Fernanda Salloume Sampaio Bonafé, João Marôco, Juliana Alvares Duarte Bonini Campos
58	P117	Locus of control between individuals with pain	Lucas Arrais de Campos, Fernanda Salloume Sampaio Bonafé, João Marôco, Juliana Alvares Duarte Bonini Campos
59	P118	Psychoeducational support with family participation increases self-help skills in patients with chronic pain: the case of fibromyalgia	Woe sook K, Masato M, Fumio S, Motoko I, Masako M, Risako M, Shnichiro M
60	P119	Emotional and cognitive functioning in patients with chronic pain	Sara Lutricuso, Domenico Laera, Jole Losole, Filomena Puntillo, Alessandro Taurino, Maria Fara De Caro
61	P120	The effect of pain and fatigue perception on depression in Japanese cancer survivors: the mediating effect of activity restriction	Kotone Hata, Haruka Ono, Yuko Ogawa, Wakana Takeshita, Shin-ichi Suzuki
62	P121	“Morbus Mediterraneum” or “Real” pain? Experts’ assessments on the causes of pain among migrant patients in the Black Forrest, Germany	Reime Birgit, Warth Patrick, Noll Markus
63	P122	“Pain is pain”. How do pain patients with migrant backgrounds perceive the cultural competence of their health care providers?	Warth Patrick, Reime Birgit, Noll Markus

Thursday, 12th September 2019

9.00-19.00

AUDITORIUM HALL

Poster num. on the poster board	Poster code	Title	Authors
64	P123	Psychosocial characteristics of chronic pain outpatients	Ajandek Eory, Timea Csepes, Dora Bekesi, Andrea Udvarhelyi, Katalin Ats, Daniel Eorsi, Zoltan Kekecs, Sandor Rozsa, Peter Torzsa
65	P124	Martyrdom in different cultures: How to cope with traumatisation?	Braun Birgit, Loew Thomas
66	P125	Ebb and Flow of the "Brown Wave": History and Psychopathology of Right-wing extremism	Braun Birgit, Loew Thomas

Friday, 13th September 2019

9.00-17.00

AUDITORIUM HALL

Poster num. on the poster board	Poster code	Title	Authors
1	P126	Clinimetric assessment of allostatic overload in patients with essential hypertension	Jenny Guidi, Marcella Lucente, Antonio Piolanti, Renzo Roncuzzi, Chiara Rafanelli, Nicoletta Sonino
2	P127	Oral squamous cell carcinoma mimicking burning mouth syndrome in elderly patients: a case series	Takayuki Suga, Lou Mikuzuki, Takeshi Watanabe, TRANG T.H TU, Miho Takenoshita, Akira Toyofuku
3	P128	Assessment of psychosomatic factors in migraine patients: results of the PAINMIG study	Andrea Svicher, Sara Romanazzo, Francesco De Cesaris, Silvia Benemei, Pierangelo Geppetti
4	P129	Hyperarousal symptoms in cardiac arrest survivors predict 12-month clinical outcomes	Alex Presciutti, Jonathan Shaffer, Jennifer Sumner, Donald Edmonson, Sachin Agarwal
5	P130	No evidence for particular association between HLA-haploidentical hematopoietic stem cell transplantation and psychological distress	Rie Akaho, Akiko Otsu, Aiko Igarashi, Yuko Aoki, Takaabu Takemura, Sayaka Kobayashi, Kazuteru Ohashi, Katsuji Nishimura
6	P131	Psychological predictors of cancer: a case-control study	Erika Maniscalco, Luana La Marca, Francesco Fabbiano, Naida Faldetta, Francesco Verderame, Noemi Rosa Maganuco, Gianluca Santoro, Adriano Schimmenti
7	P132	Solution Focused Coaching for patients suffering from functional dyspepsia symptoms with stressors	Mitsuru Moriya
8	P133	Treatment of psychiatric comorbidities in epilepsy patients with different diagnostic systems and their relation with quality of life	Ayşe Terzi, Nilüfer Sayılğan, Hüseyin Güleç
9	P134	Implicit emotional processing in fibromyalgia: an experimental study	Federica Scarpina, Ada Ghiggia, Giorgia Varallo, Valentina Tesio, Alessandro Maurod, Marco Arreghini, Paolo Capodaglio, Enrico Molinari, Lorys Castelli, Gianluca Castelnuovo

Friday, 13th September 2019

9.00-17.00

AUDITORIUM HALL

Poster num. on the poster board	Poster code	Title	Authors
10	P135	The state of psychological distress in Japanese Narcolepsy patients	Sayaka Kon, Chieko Kato, Yoshiomi Otsuka, Takako Negishi, Kouichirou Aoki
11	P136	Low body weight seen in eating disorders means the body weight prior to the menarche, and this phenomenon means the existence of "intracerebral calendar"	Yutaka Suzuki
12	P137	The influence of psychosocial characteristics on the delayed diagnostic of cancer patients (stage evaluation)	Mara Jidveian Popescu, Ovidiu Popa-Velea, Adela Ciobanu
13	P138	Diagnostic Criteria for Psychosomatic Research and psychosocial functioning in tinnitus	Domenico Laera, Maria Fara De Caro, Alessandro Taurino, Daniele D'Erasmus, Antonella Pinto, Piero Fanizzi, Nicola Quaranta
14	P139	Exploratory research on post-traumatic growth observed in group psychotherapy for advanced cancer patients	Mayumi Ishida, Takao Takahashi, Hideki Onishi
15	P140	Thiamine deficiency in the cancer-bearing after the death of a spouse	Hideki Onishi, Takao Takahashi, Izumi Sato, Mayumi Ishida
16	P141	Experience in treating psychosomatic diseases with Wuling Capsule	Li Jing, Wang Mingwei
17	P142	Effects of weight loss on sweet taste preference and palatability following cognitive behavioral therapy in women with obesity	Takehiro Nozaki, Tomoe Nishihara, Ryoko Sawamoto, Gen Komaki, Noriyuki Miyata, Masako Hosoi, Nobuyuki Sudo
18	P143	Are cognitive behavioral strategies to increase adherence to exercise effective for long-term weight loss maintenance by women with overweight and obesity? A randomized controlled trial	Takehiro Nozaki, Ryoko Sawamoto, Tomoe Nishihara, Gen Komaki, Nobuyuki Sudo
19	P144	Medication nonadherence after kidney transplantation in Japan	Sayaka Kobayashi, Junko Tsutsui, Sachi Okabe, Ishida Hideki, Satoko Matsui, Hidehiro Oshibuchi, Rie Akaho, Katsuji Nishimura

Friday, 13th September 2019

9.00-17.00

AUDITORIUM HALL

Poster num. on the poster board	Poster code	Title	Authors
20	P145	Factors associated with anxiety of patients in Palliative Care Unit	Tetsuya Ito, Yuki Yano, Kiyozumi Takei, Naoko Takahashi, Fumio Shaku
21	P146	Refeeding syndrome after "paleodiet" and psychosomatic background	Marta Kalousova, Jaroslav Macasek, Miroslav Zeman
22	P147	A survey on lifestyle and awareness of the use of statins in a sample of cardiopathic patients	Sara Gostoli, Francesco Bernardini, Gabriello Marchetti, Paola Grazi, Maria Grazia Poci, Renzo Roncuzzi, Chiara Rafanelli
23	P148	Psychosomatic syndromes among haemophilia patients: experimental contribution	Marco Miniotti, Francesca Zizzi, Mariagiulia Bailon, Alessandra Borchiellini, Federica Valeri, Paolo Leombruni
24	P149	The efficacy of brief psychodynamic psychotherapy for fibromyalgia: A pilot study	Annunziata Romeo, Valentina Tesio, Ada Ghiggia, Marialaura Di Tella, Virginia Perutelli, Lorys Castelli
25	P150	Use of the Diagnostic Criteria for Psychosomatic Research (DCPR) in a sample of overweight or obese patients with type 2 diabetes	Giada Benasi, Sara Gostoli, Giulia Buttiglione, Chiara Rafanelli
26	P151	Somatization in patients with Parkinson's Disease	Chiara Patierno, Danilo Carrozzino
27	P152	Relationship between employment sector and cancer diagnoses	Nicholas Boston, Ryan Bennett, Andrew Solow, Barry Nierenberg
28	P153	Factors promoting and obstructing communications with children when mothers have cancer	Yuko Ogawa, Michiko Hisano, Miwa Ozawa, Shin-ichi Suzuki
29	P154	Is cardiac atrophy of anorexia nervosa reversible?	Ui Yamada, Yoko Ichiki, Komei Shibata, Daisuke Ohta
30	P155	Possible role of gut microbiota in pathology of anorexia nervosa	Tomokazu Hata, Noriyuki Miyata, Shu Takakura, Kazufumi Yoshihara, Yasunari Asano, Tae Kimura-Todani, Makoto Yamashita, Nobuyuki Sudo
31	P156	Irritable Bowel Syndrome: can it be "put to sleep" with hypnosis?	Elsa Fernandes, Maria João Gonçalves, Lúgia Castanheira

Friday, 13th September 2019

9.00-17.00

AUDITORIUM HALL

Poster num. on the poster board	Poster code	Title	Authors
32	P157	Effects of holistic psychotherapy and mindfulness on quality of life, pain, and Temperament and Character (TCI) in women affected by fibromyalgia	Anna Vespa, Marica Ottaviani, Maria Velia Giulietti
33	P158	Pre-Transplant Sense of Coherence (SOC) in end-stage organ failure is not predictive for post-transplant trajectories of mental health and quality of life. Preliminary Results from The Swiss Transplant Cohort Study	Annina Seiler, Hanspeter Mörgele, Roland von Känel, Josef Jenewein, for the Psychosocial Interest Group, Swiss Transplant Cohort Study
34	P159	Clinimetric approach to rating scales for the assessment of somatization in gastroenterology: A systematic review	Danilo Carrozzino, Chiara Patierno
35	P160	Post-SSRI Sexual Dysfunction: results of an online survey	Arianna Patacchini, Andrea Svicher, Fiammetta Cosci
36	P161	Post-SSRI Sexual Dysfunction: a paradigmatic case or withdrawal after discontinuation of SSRI?	Arianna Patacchini, Fiammetta Cosci
37	P162	The effect of laughter measured by scoring facial expressions: observation study	Ryo Sakamoto, Hiromichi Matsuoaka, Atsuko Koyama
38	P163	Body Appearance (dis)Satisfaction Scale: psychometric properties	Juliana Alvares Duarte Bonini Campos, Júlia Valério Barra, Wanderson Roberto da Silva, João Maroco
39	P164	Cultural adaptation and psychometric properties of Attention to Body Shape Scale to Portuguese language in adults	Juliana Alvares Duarte Bonini Campos, Patrícia Angélica Teixeira, Wanderson Roberto da Silva, João Maroco
40	P165	Exercise Motivations Inventory (EMI-2): a new factorial model	Lucas Arrais de Campos, Adrielly dos Santos, João Marôco, Juliana Alvares Duarte Bonini Campos

Friday, 13th September 2019

9.00-17.00

AUDITORIUM HALL

Poster num. on the poster board	Poster code	Title	Authors
41	P166	Development of a screening form for Japanese adolescent and young adult patients with cancer: a work in progress	Takatoshi Hirayama, Yuko Yanai, Hiroto Ishiki, Akie Shindo, Moeko Tanaka, Tomomi Kobayashi, Tatsuya Suzuki, Ken Shimizu, Eriko Satomi
42	P167	Validation of a brief scale assessing eating self-efficacy	Caterina Lombardo, Silvia Carolini, Fabio Alivernini, Andrea Ballesio, Mariana Fernandes, Cristiano Violani, Fabio Lucidi
43	P168	Japanese version of Family Coping Questionnaire for Eating Disorders	Seraki Miyamoto, Tadahiro Yamazaki, Saki Harashima, Akira Kobayashi, Aiko Koga, Yukari Yamanaka, Nobuhiro Nohara, Yukariko Hida, Maiko Hiraide, Ryo Yoneda, Junko Moriya, Takeshi Horie, Makoto Otani, Kazuhiro Yoshiuchi
44	P169	The Psychosomatic Dysregulation Inventory (PDI): Italian validation in a clinical sample	Caretti V, Schimmenti A, Porcelli P, Temperani D, Temperani A, Tizi C, Baldoni F
45	P170	Developing "the Questionnaire for Alexicosmia" measuring personal cognitive features for yoga therapy assessments	Aiko Nakata, Minoru Kamata, Keishin Kimura, Chieko Kato, Keiko Kioka
46	P171	Sydney Melancholia Prototype Index (SMPI): translation and cross-cultural adaptation into Brazilian Portuguese	Mateus Messinger, Marco Caldieraro, Bruno Mosqueiro, Felipe Costa, Gabriela Possesbon, Pedro Santos, Gordon Parker, Marcelo Fleck
47	P172	Application of the Sydney Melancholia Prototype Index (SMPI) in a Brazilian sample of depressive patients	Mateus Messinger, Marco Caldieraro, Bruno Mosqueiro, Felipe Costa, William Barcelos, Pedro Santos, Gordon Parker, Marcelo Fleck
48	P173	The Analogical Symptom Assessment (ASA): validation in a sample of new parents during the prenatal period	Franco Baldoni, Roberta Mandolesi, Francesca Agostini, Mattia Minghetti, Michele Giannotti, Nicola Ambrogetti, Simone Peverieri, Licia Massa, Federico Spelzini

Friday, 13th September 2019

9.00-17.00

AUDITORIUM HALL

Poster num. on the poster board	Poster code	Title	Authors
49	P174	The Analogical Symptom Assessment (ASA): validation study in a sample of patients in psychotherapy	Franco Baldoni, David Temperani, Alessandro Temperani, Caterina Tizi, Michele Giannotti
50	P175	Psychosomatic Medicine and Consultation-Liaison Psychiatry world-wide – different? Accepted? Certified?	Hoyle Leigh
51	P176	The Modena Consultation-Liaison Psychiatry Service in the general hospital: a cross-sectional study	Melissa Cherubini, Giulia Rioli, Jessica Balducci, Silvia Ferrari, Luigi Zerbini, Luigi Grassi
52	P177	Urgent vs. routine psychiatric referrals in the General Hospital: what makes the difference? A cross-sectional study at the Modena Consultation-Liaison Psychiatry Service	Melissa Cherubini, Giulia Rioli, Jessica Balducci, Silvia Ferrari, Luigi Zerbini, Luigi Grassi
53	P178	The frequency of SOC by age which is the concept of healthy	Fujiko Konjiki, Midori Umehar, Chiemi Nakamoto, Reiko Matsumoto, Yuki Sawada, Yumi Nakagome
54	P179	Psychiatric indication for choice of birth route?	Lucas Santos Argolo, Fernanda S Correia-Melo, Fernanda de Araujo Oliveira, Lillian Santana Santos, Arthur Melo Lemos Couto, Raiza Martina Carneiro Martins, Robert Pedrosa
55	P180	Practice of “evergreening” on psychiatric medications and its impact to consumers and society	Joy K.L Andrade, Junji Takshita, Earl S. Hishinuma
56	P181	Psychological and functional recovery in rehabilitative practice	Laura Gestieri, Caterina Romaniello, Gloria Leonardi, Stefania Prostrati, Maria Rosaria Leo, Daniela Cevolani, Marina Farinelli
57	P182	Insights into the formation of a trusting therapeutic relationship: feasibility of an experimental approach	Isabel Schamong, Simon Bolmann, Nele Struck, Tobias Kube, Lisa D’Astolfo, Eva-Lotta Brakemeier

Friday, 13th September 2019

9.00-17.00

AUDITORIUM HALL

Poster num. on the poster board	Poster code	Title	Authors
58	P183	Nosography in psychosomatic medicine: a hot topic	Sara Romanazzo, Andrea Svicher, Francesco De Cesaris, Silvia Benemei, Pierangelo Geppetti, Fiammetta Cosci
59	P184	Inter-rater reliability of the DID-W1 Clinical Interview	Magda Boi, Andrea Svicher, Fiammetta Cosci
60	P185	The mind-body relation in a group of adolescents at-risk for psychotic onset	Camilla Guccione, Anna Chiara Franquillo, Gianmaria Temporin, Gianmarco Tressari, Lavinia Celsan, Gianluigi Di Cesare, Giuseppe Ducci
61	P186	Effect of low dose aripiprazole on amitriptyline-intolerant burning mouth syndrome	Takeshi Watanabe, Shunsuke Takano, Kohsuke Abe, Shiori Sugawara, Kaoru Kawasaki, Kazuhito Miura, Takayuki Suga, Lou Mikuzuki, Chaoli Hong, Tu Thi Huyen Trang, Kazuya
62	P187	Neurophysiological changes in depressed patients with unresolved attachment during long-term psychotherapy	Anna Buchheim, Roberto Viviani, Henrik Kessler, Svenja Taubner, Horst Kächele, Gerhard Roth, Oliver Pogarell, Susanne Karch, Karin Labek
63	P188	Development of a cognitive behavior therapy program for university students experiencing difficulty with academic adjustment	Sayaka Ogawa, Jun Tayama, Kiriko Yanai, Masaki Hayashida, Peter Bernick, Masakazu Kobayashi, Ikuko Sagara, Susumu Shirabe